

Instructions

Notice de montage

Bauanleitung

Istruzioni di montaggio

Instrucciones de montaje

Instruções de montagem

Monteringsanvisning

Kokoamisohje

Monterings instruktioner

Montagehandleiding

Οδηγίες συναρμολόγησης.

組立説明書





- Ⓒ The battery housing and the motor shown in the instructions have been replaced.
- Ⓕ Le boîtier de piles et le moteur présentés dans la notice ont été remplacés.
- Ⓖ Das in der Gebrauchsanweisung gezeigte Batteriegehäuse sowie der Motor wurden ersetzt.
- Ⓘ Il vano pile ed il motore presentati nelle istruzioni per l'uso sono stati sostituiti.
- Ⓔ La caja de pilas y el motor presentados en las instrucciones han sido sustituidos.
- ⒫ O compartimento de pilhas e o motor apresentados nas instruções foram substituídos.
- Ⓒ Batterilådan och motorn som presenteras i notisen har ersatts.
- Ⓕ Ohjekirjassa esitetyt paristokotero ja moottori on vaihdettu.
- Ⓖ Batteridåsen og motoren, som er vist i vejledningen, er blevet udskiftet.
- Ⓘ Het batterijcompartiment en de motor uit de handleiding zijn vervangen.
- Ⓕ Το πακέτο μπαταριών και το μοτέρ που παρουσιάζονται στις οδηγίες αντικαταστάθηκαν.
- Ⓕ モデル組立てを目録にするために、説明書内の電池ボックスとモータが新型になりました。

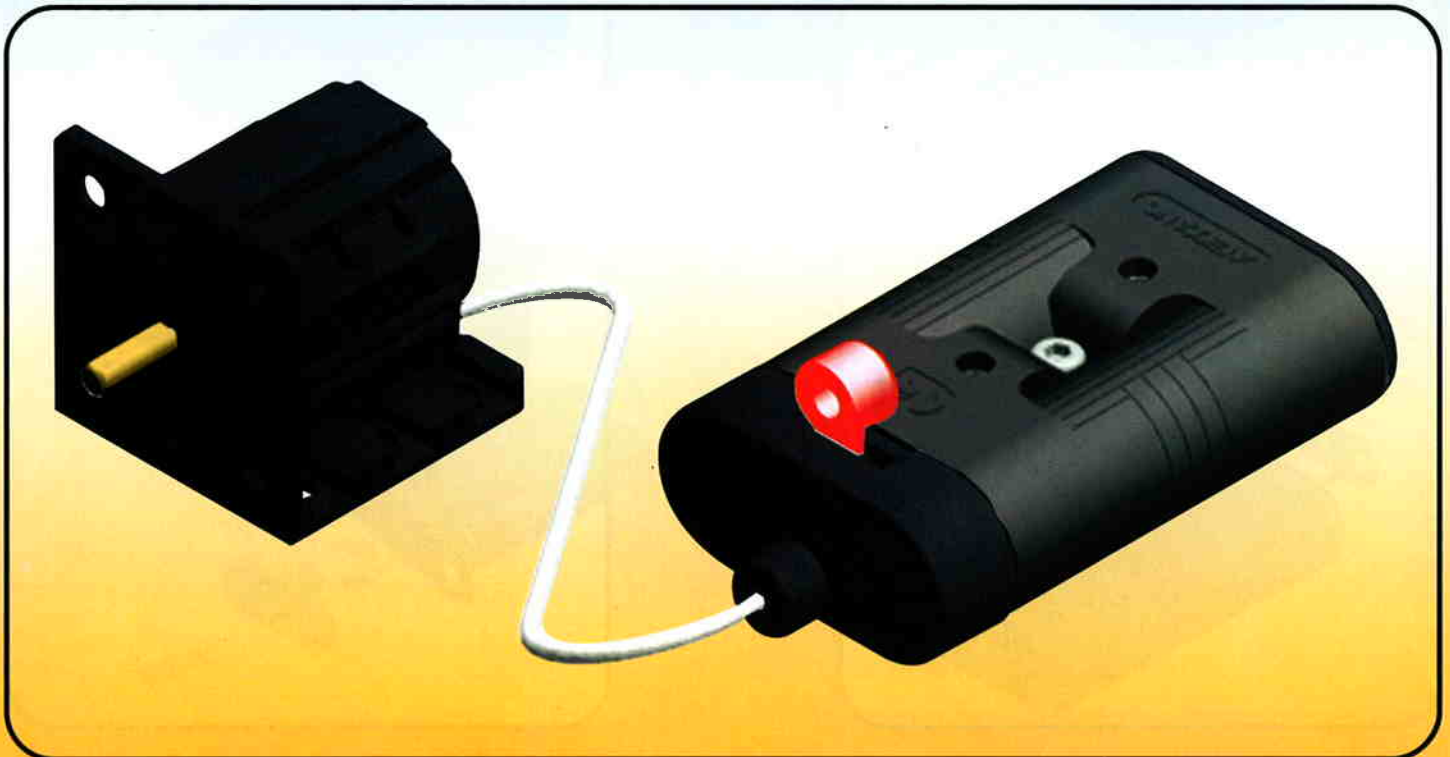
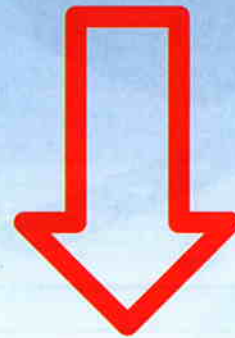
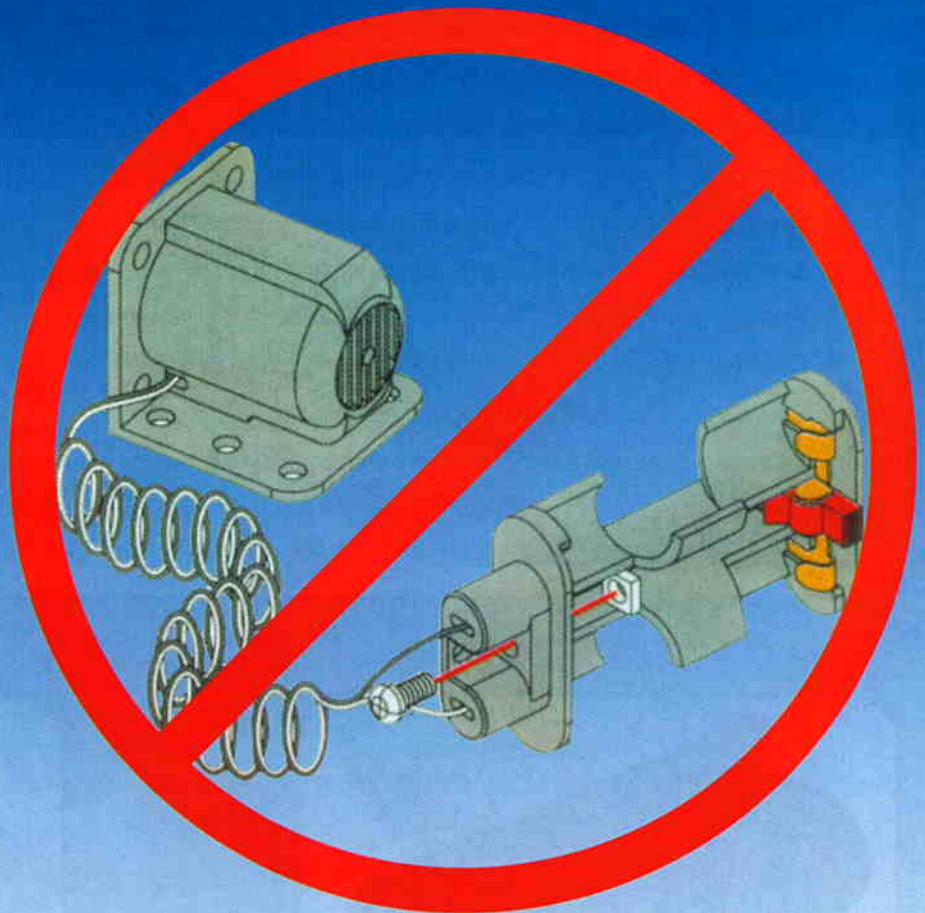

- ⓖⓑ Assembly examples of the new battery housing and the new motor.
- ⓕⓁ Exemples de montage du nouveau boîtier de piles et du nouveau moteur.
- ⓓⓂ Montagebeispiele mit dem neuen Batteriegehäuse und dem neuen Motor.
- ⓐⓂ Esemplio di montaggio del nuovo vano pile e del nuovo motore.
- ⓔⓂ Ejemplos de montaje de la nueva caja de pilas y del nuevo motor.
- ⓔⓂ Exemplos de montagem do novo compartimento de pilhas e do novo motor.
- ⓈⓂ Exempel på montering av den nya batterilådan och den nya motorn.
- ⓕⓂⓃ Uuden paristolokeron ja uuden moottorin asennusesimerkki.
- ⓓⓀ Eksempler på montering af den nye batteridåse og den nye motor.
- ⓃⓁ Montagevoorbeelden van het nieuwe batterijcompartiment en de nieuwe motor.
- ⓖⓂ Παράδειγματα συναρμολόγησης του νέου πακέτου μπαταριών και του νέου μοτέρ.
- ⓙⓅ 新型電池ボックスと新型モータの組立て例

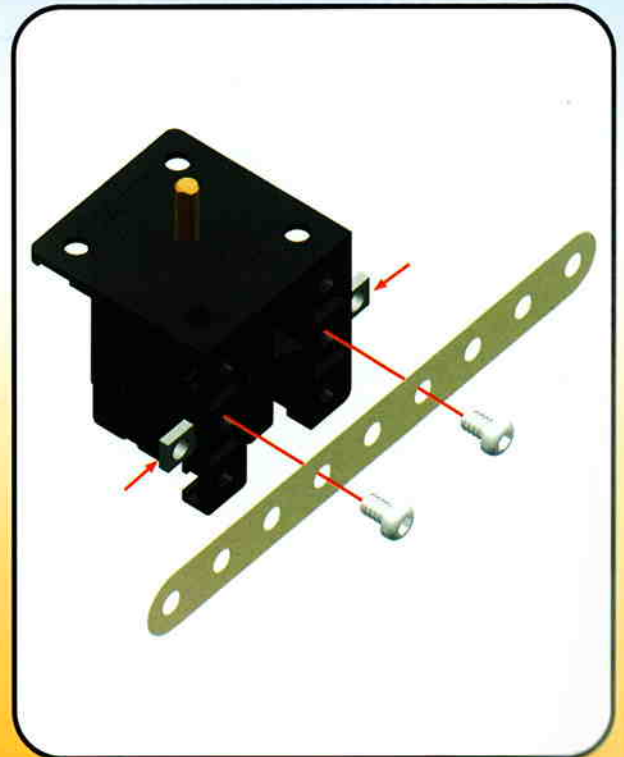
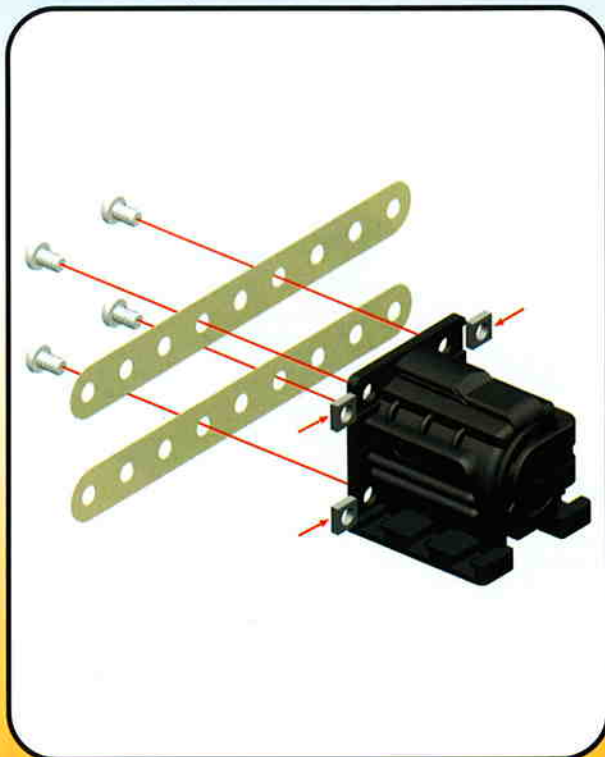
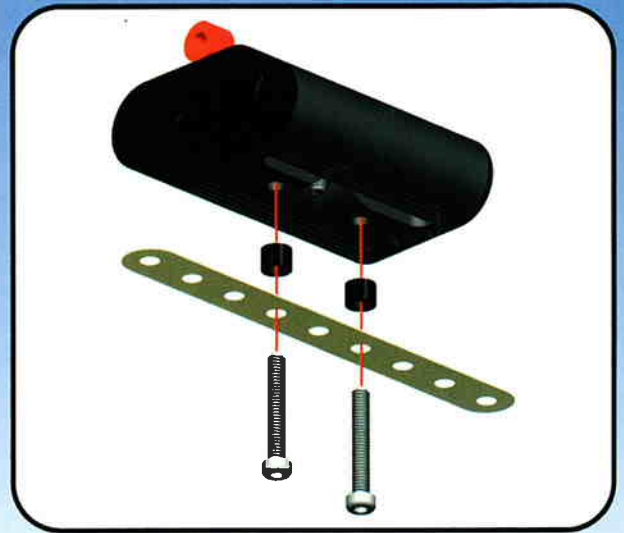
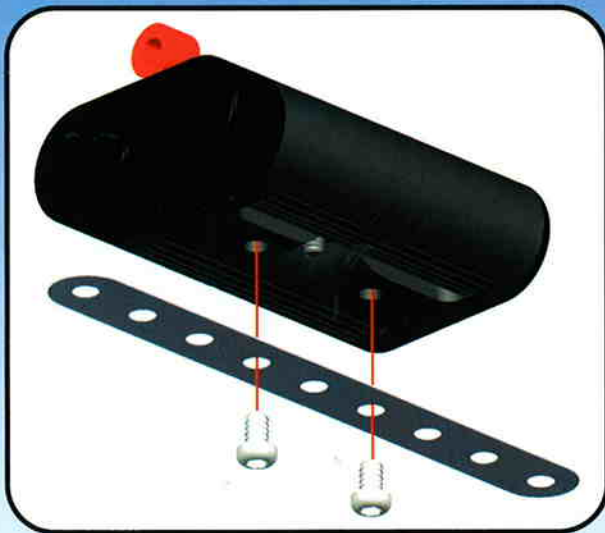

1



2



3



4



5

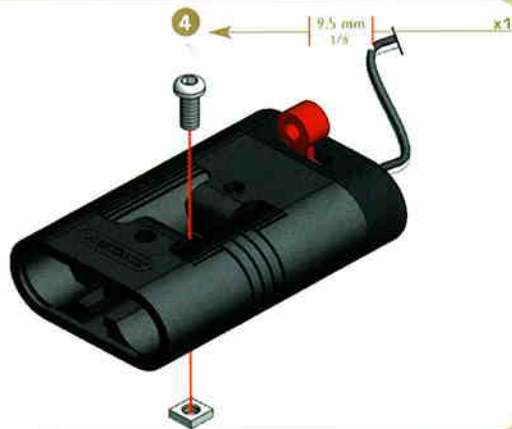

6

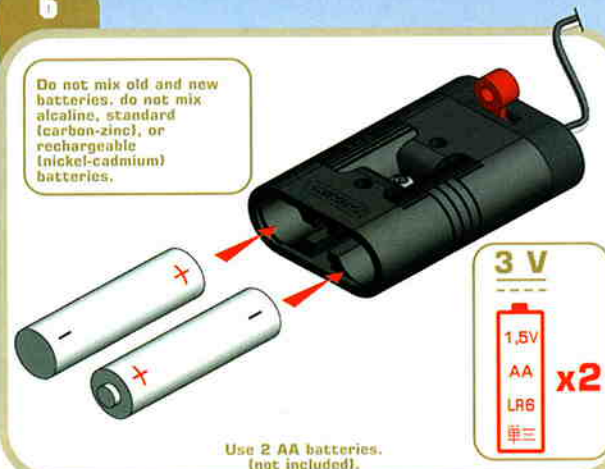

Use 2 AA batteries.
(not included).

7

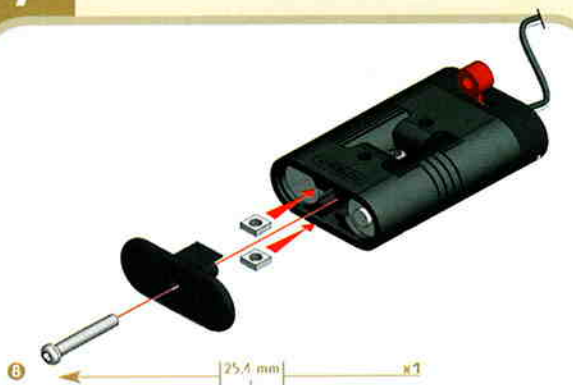

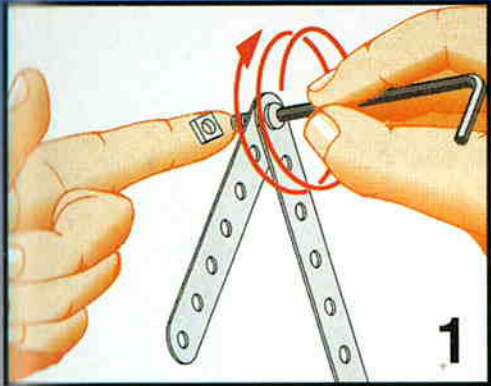

1

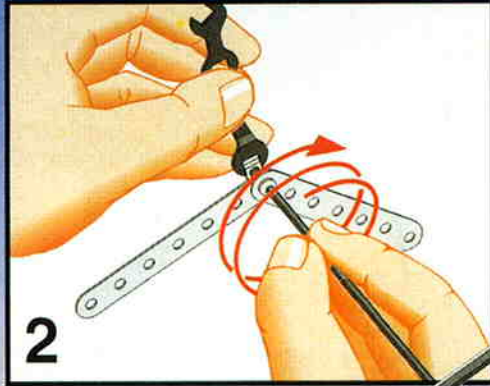

2

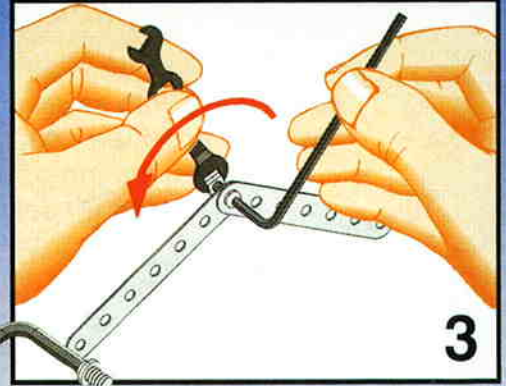

3

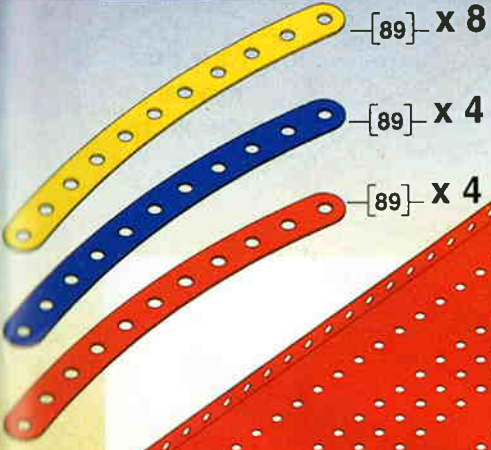
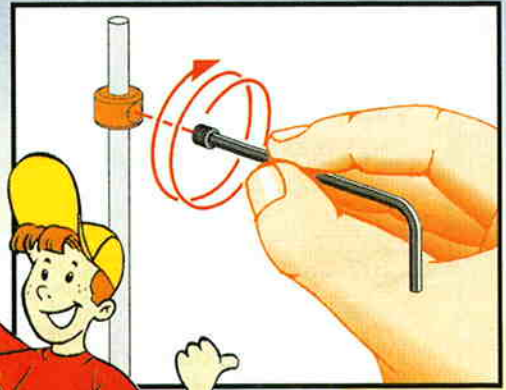

[89] x 8

[89] x 4

[89] x 4

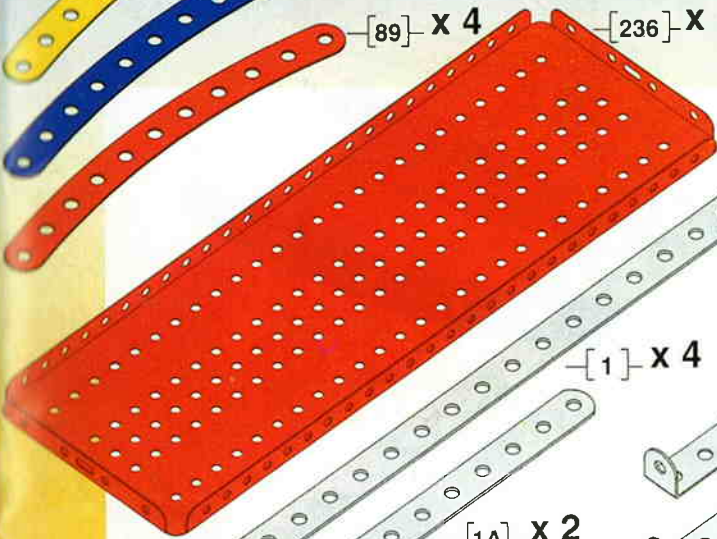

[236] x 1

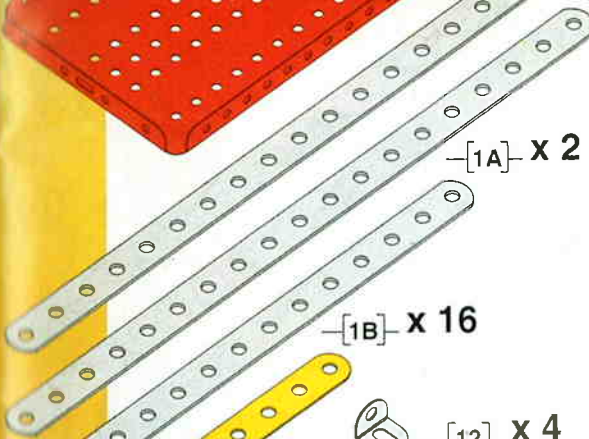

[1] x 4

[1A] x 2

[1B] x 16

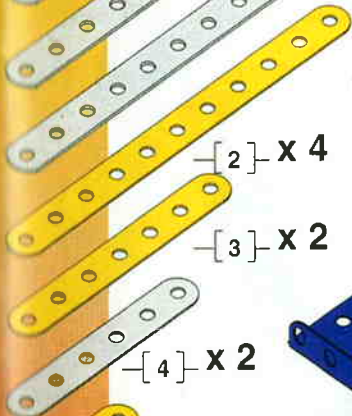

[12] x 4

[2] x 4

[3] x 2

[4] x 2

[6] x 12

[6] x 10

[6] x 10

[77] x 2



[12c] x 8

[51] x 3

[51] x 3

[51] x 2

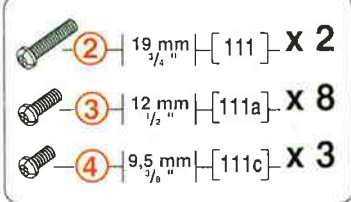

[2] 19, mm [111] x 2

[3] 12, mm [111a] x 8

[4] 9,5 mm [111c] x 3

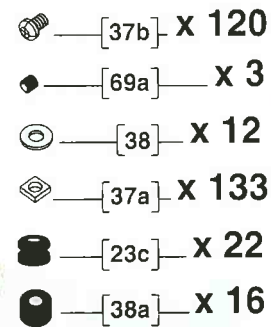

[37b] x 120

[69a] x 3

[38] x 12

[37a] x 133

[23c] x 22

[38a] x 16

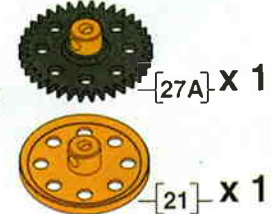

[27A] x 1

[21] x 1

[22] x 1



[46a] x 1

[48a] x 4

[48] x 1

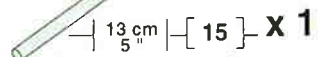

[13 cm] [15] x 1



[9 cm 3/8"] [16] x 8



[6 cm 1/2"] [16a] x 2

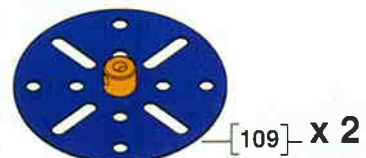

[109] x 2

[32] x 1

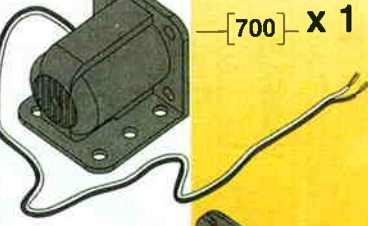

[700] x 1

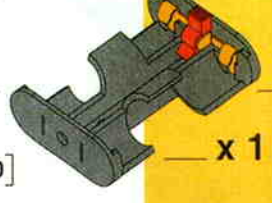

x 1

x 2

x 2

x 1



[186A] x 2

[36c] x 1

[36d] x 1

[34] x 1



Discover the method of assembling with screws and nuts, the tools and their use, the set-up principles, the fun of building working models.

Follow the step by step assembly ; this progression will guide you and you will succeed in making the models.

Choose the necessary parts by following each step.

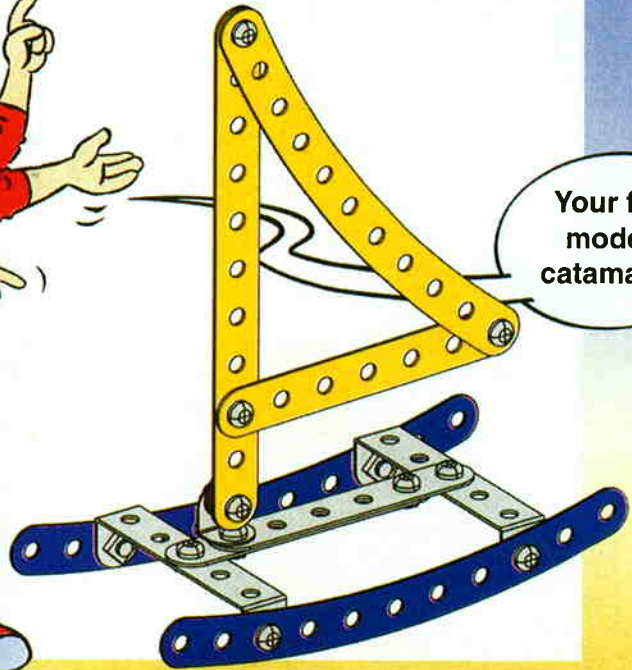

Your first model : catamaran.

1

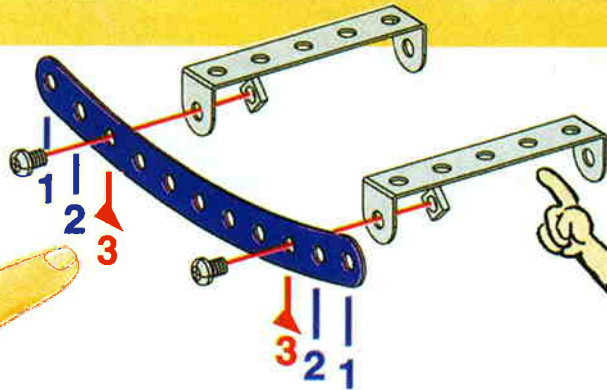
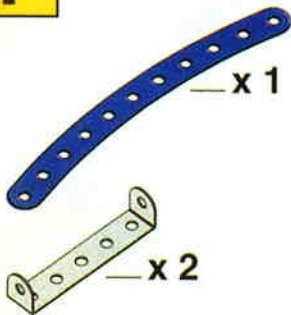

2 1+

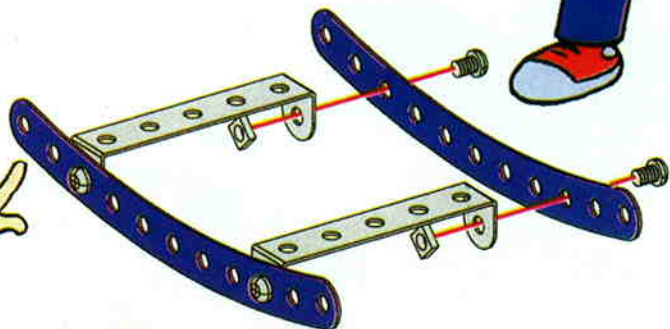
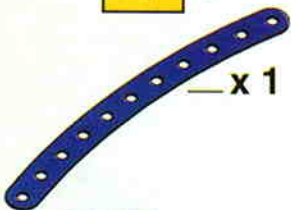

3

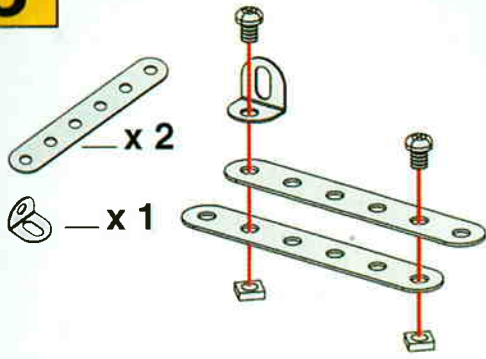

4

2 + 3

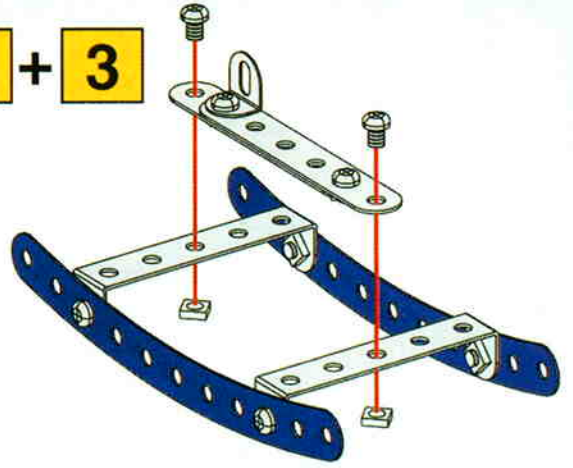

5

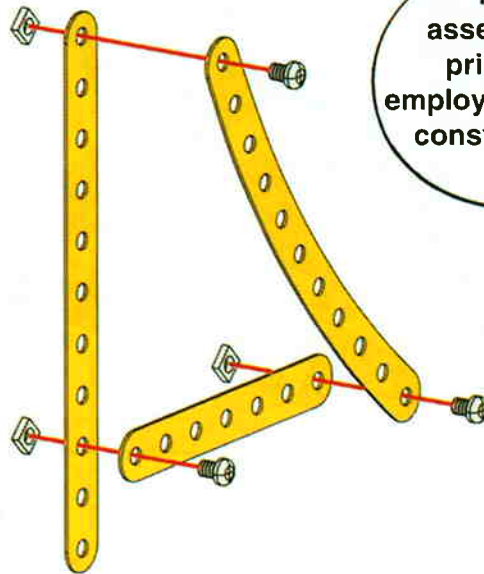
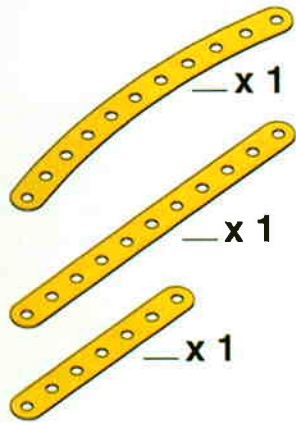

Rigid assemblies :
principles
employed for solid
constructions.

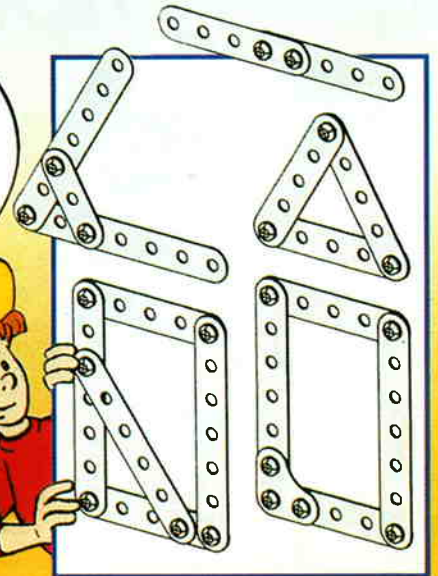

It works !
Congratulations !
You have
succeeded in
making your first
model !

6

4 + 5 +

③ | 12 mm | x 1
● x 1

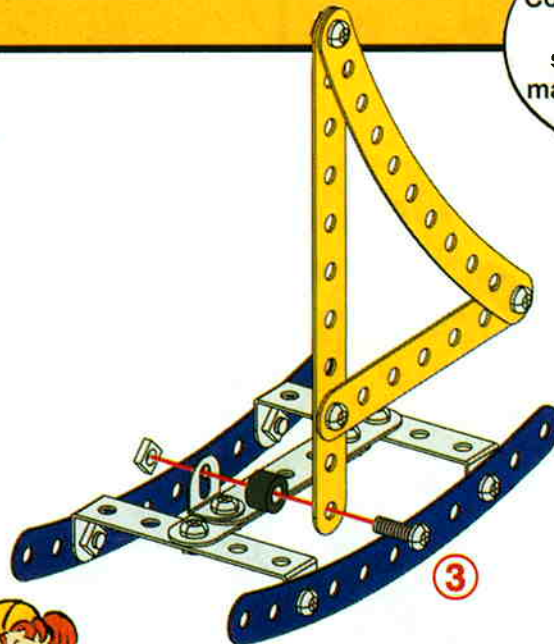



1

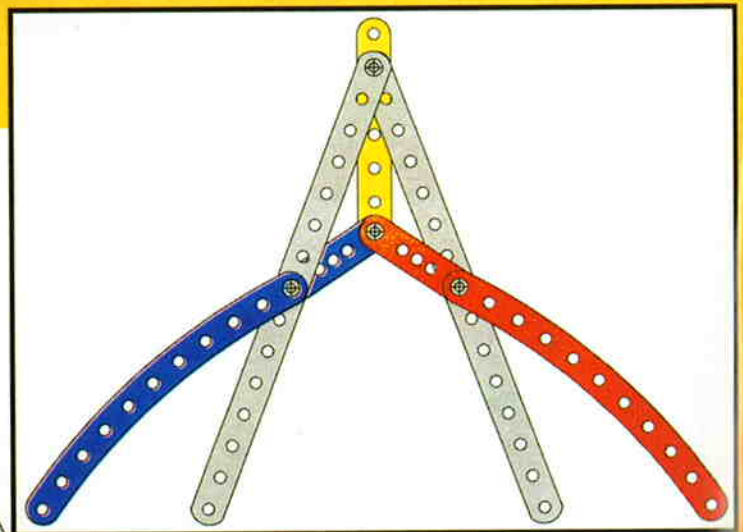
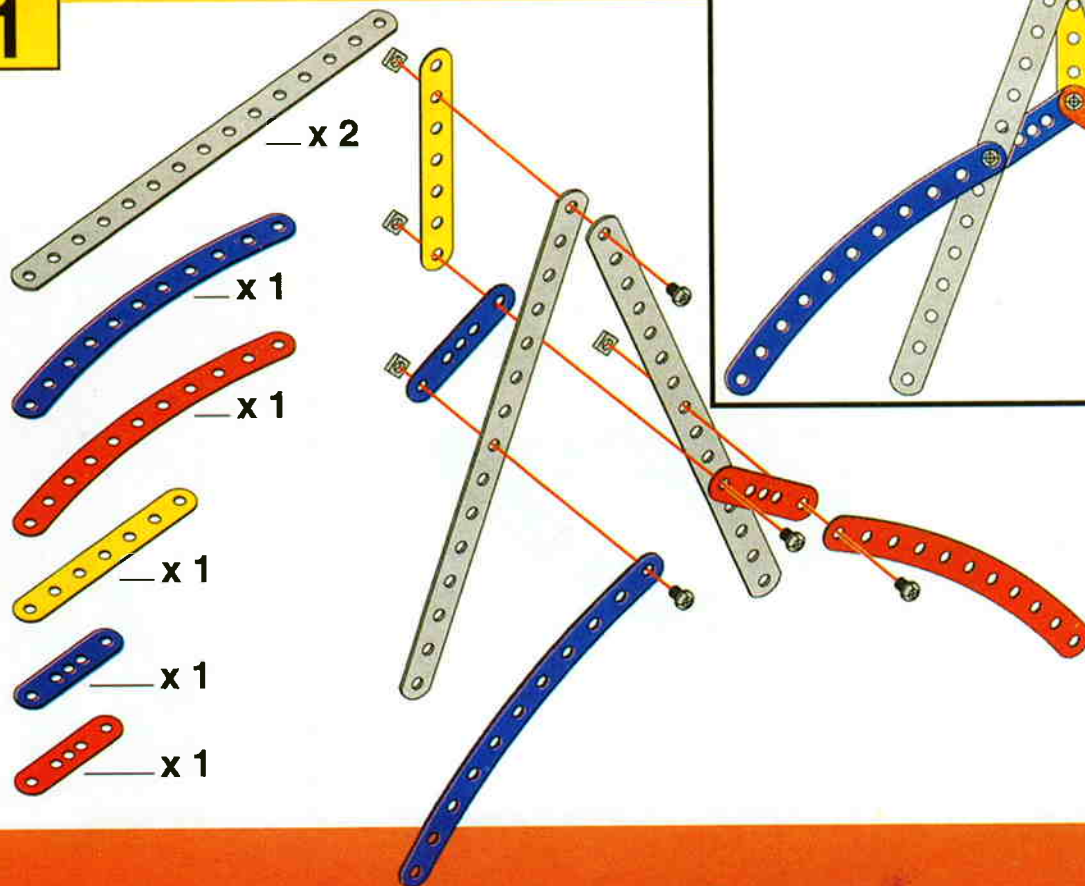

5

2 + 4 +

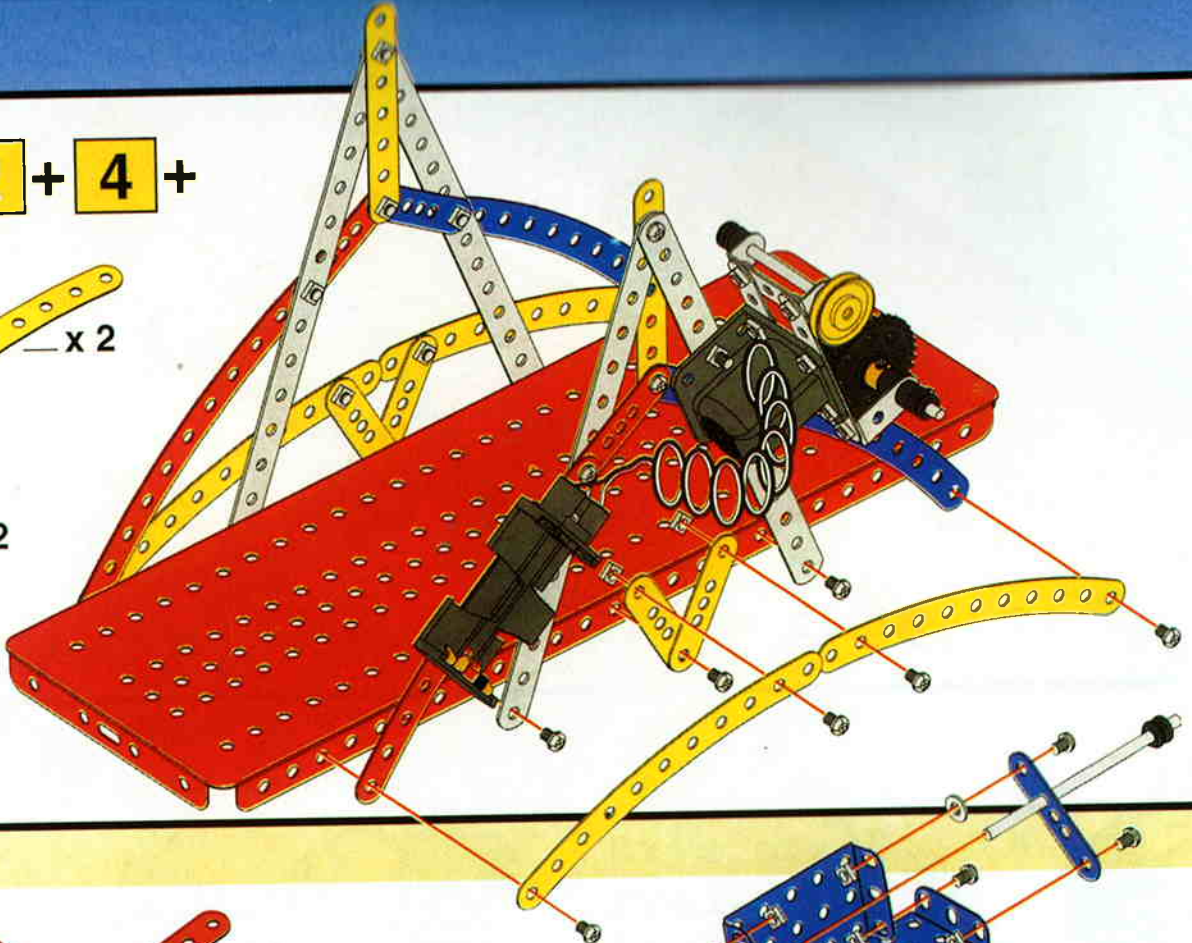
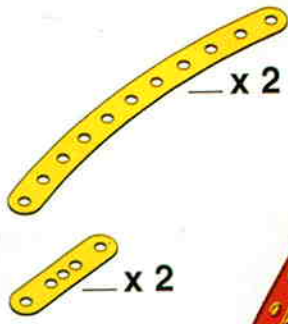

6

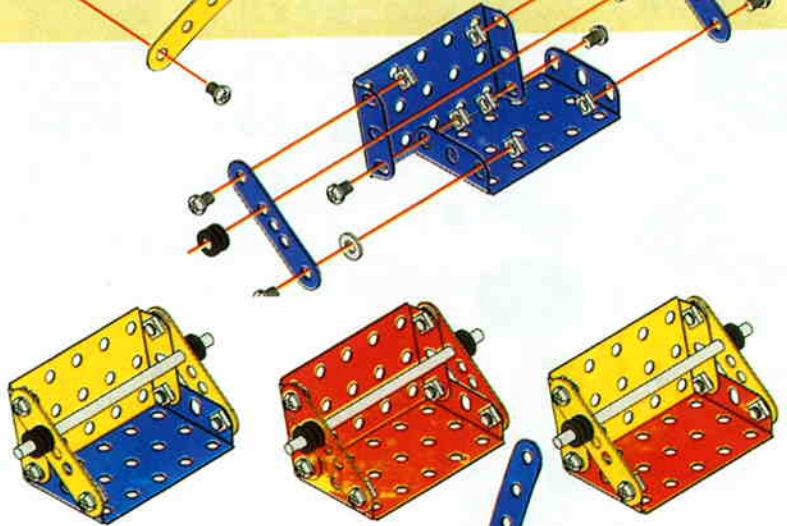
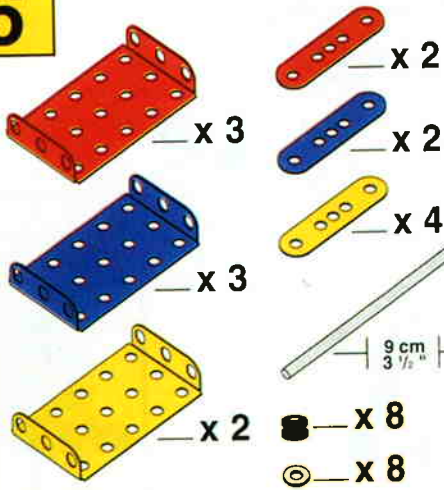

7

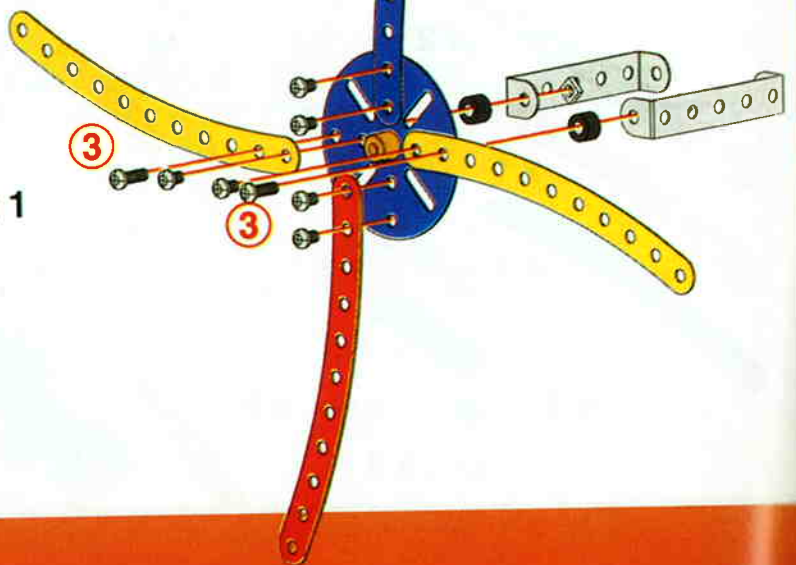
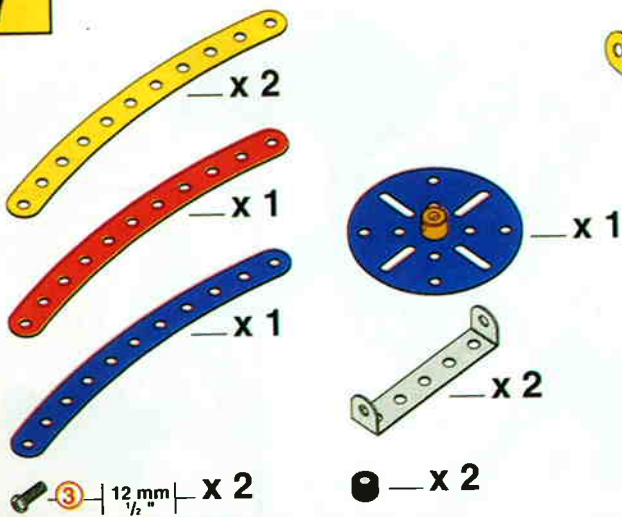

8

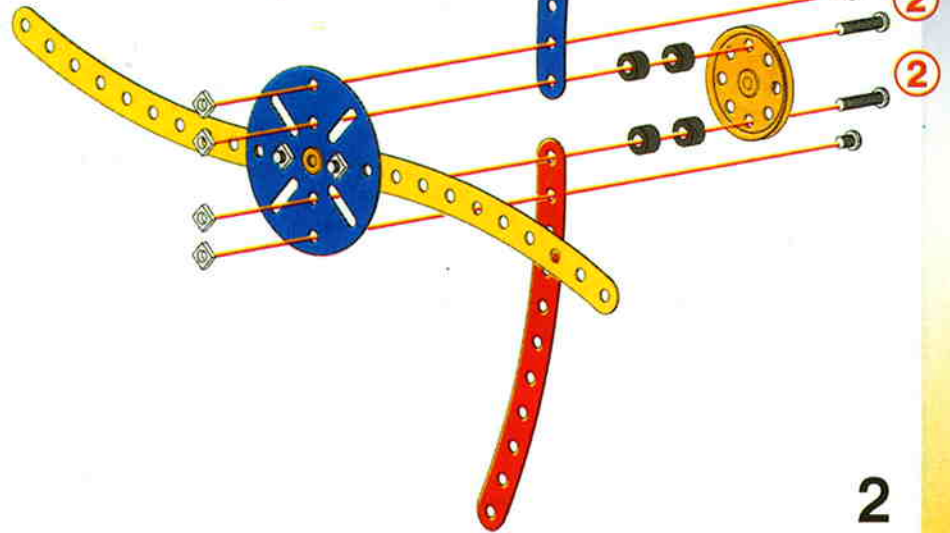
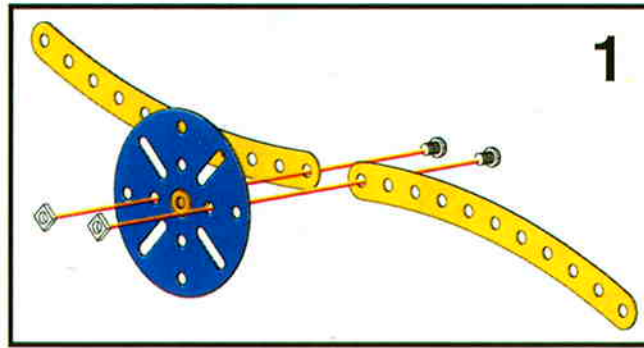
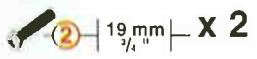
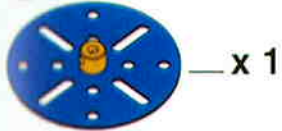
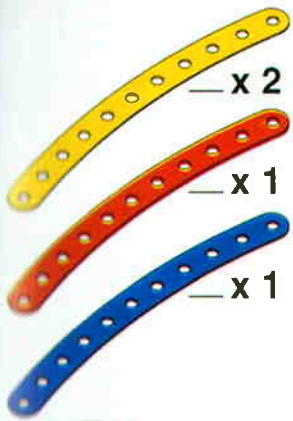

2

9

7 + 8 +

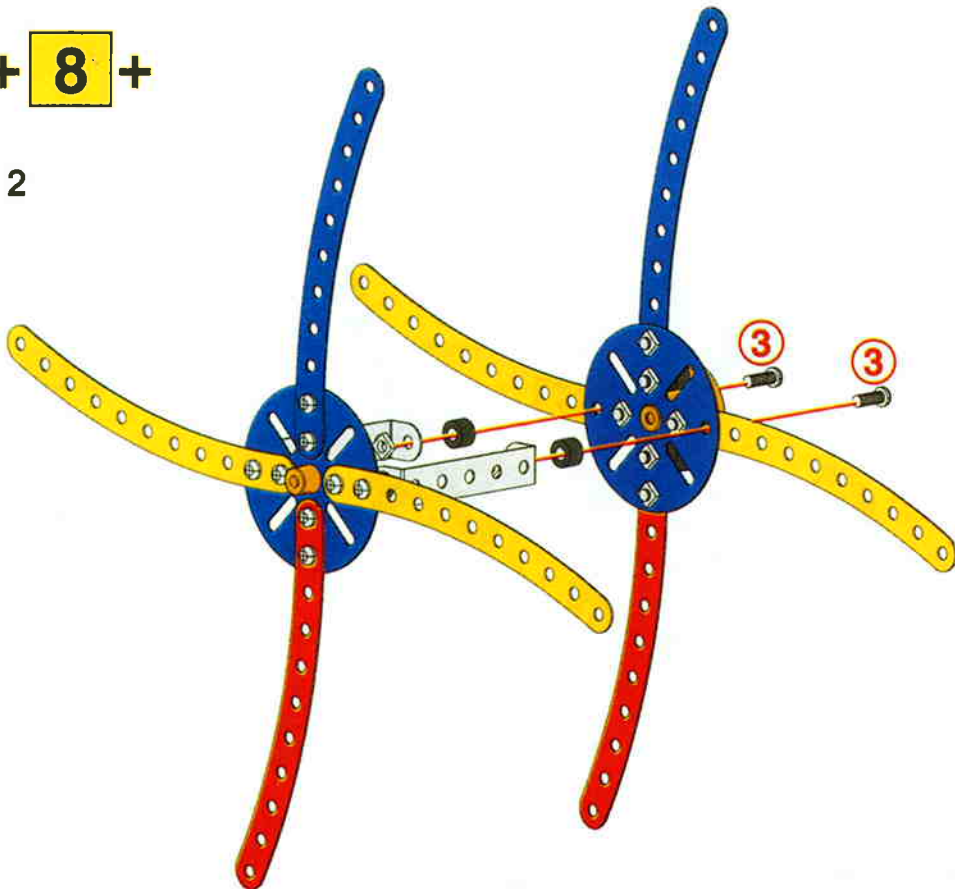
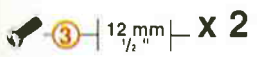

9

10 5 + 9 +

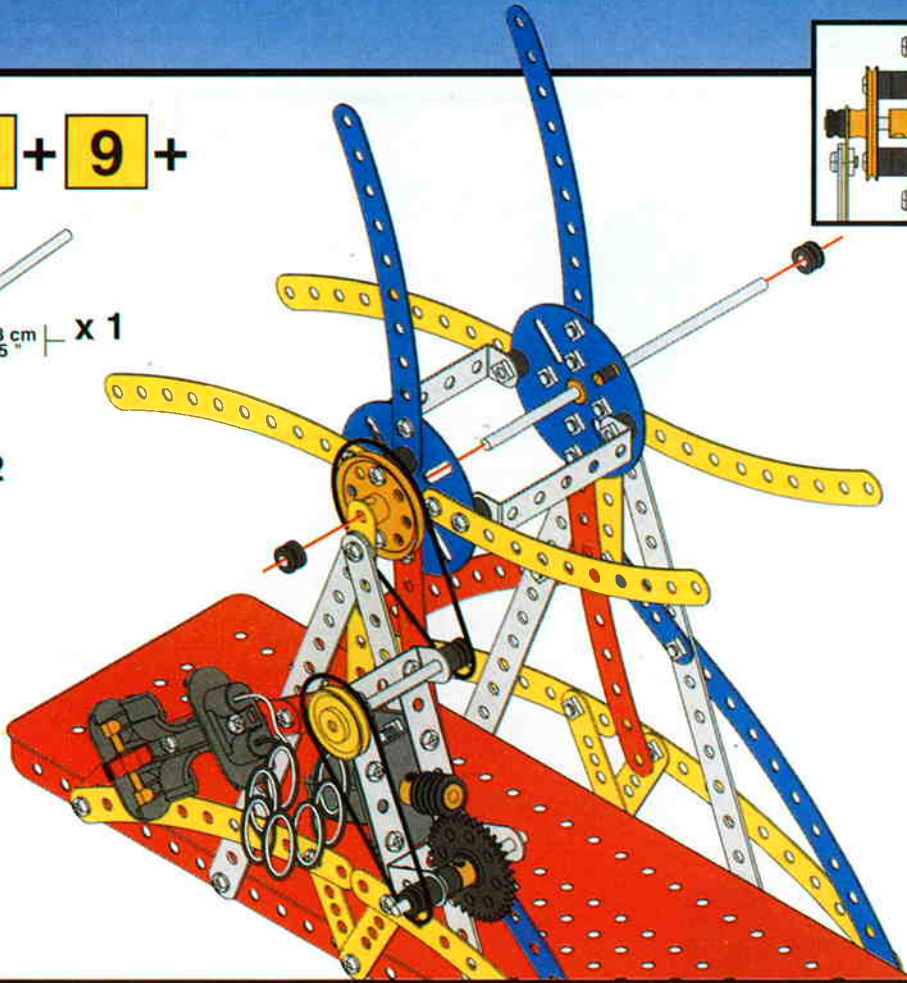
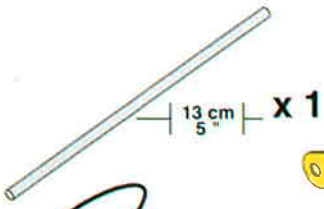

11 6 + 10 +

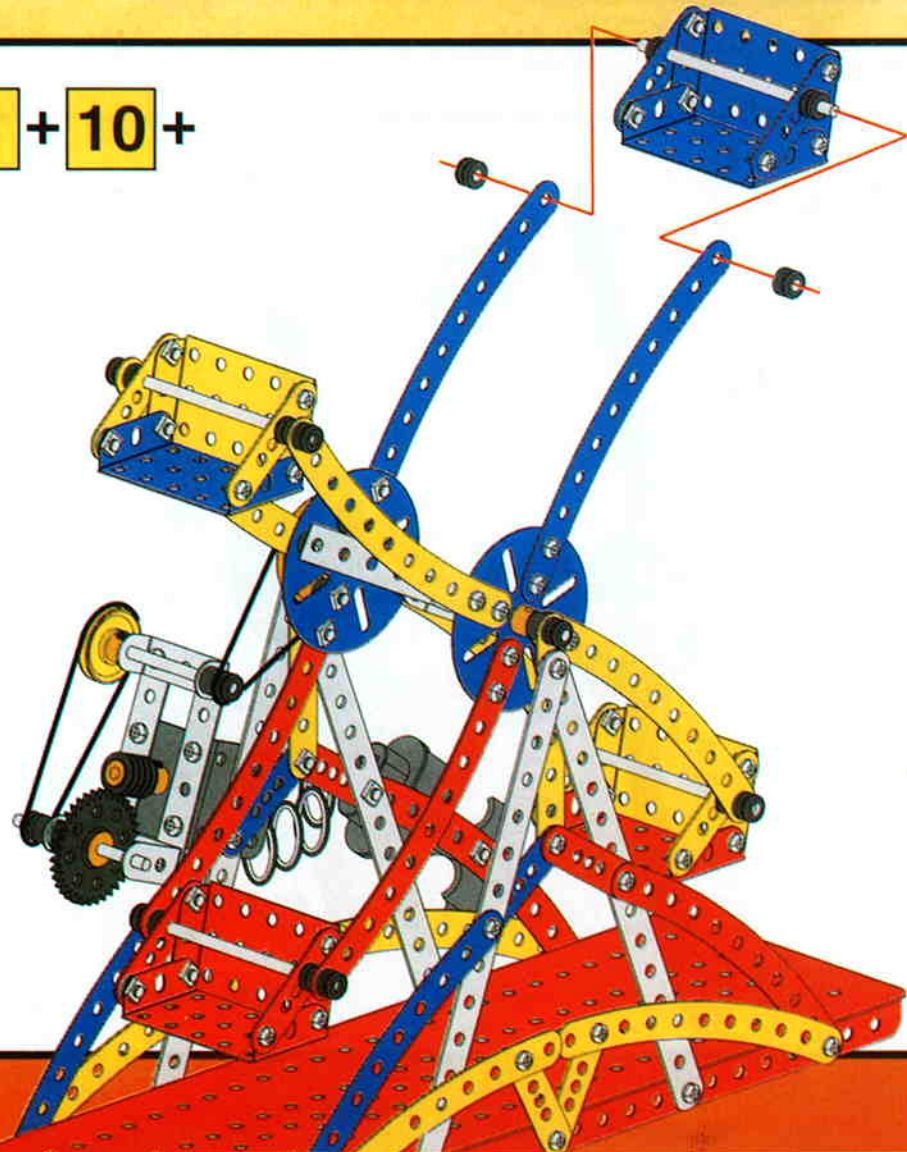
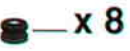

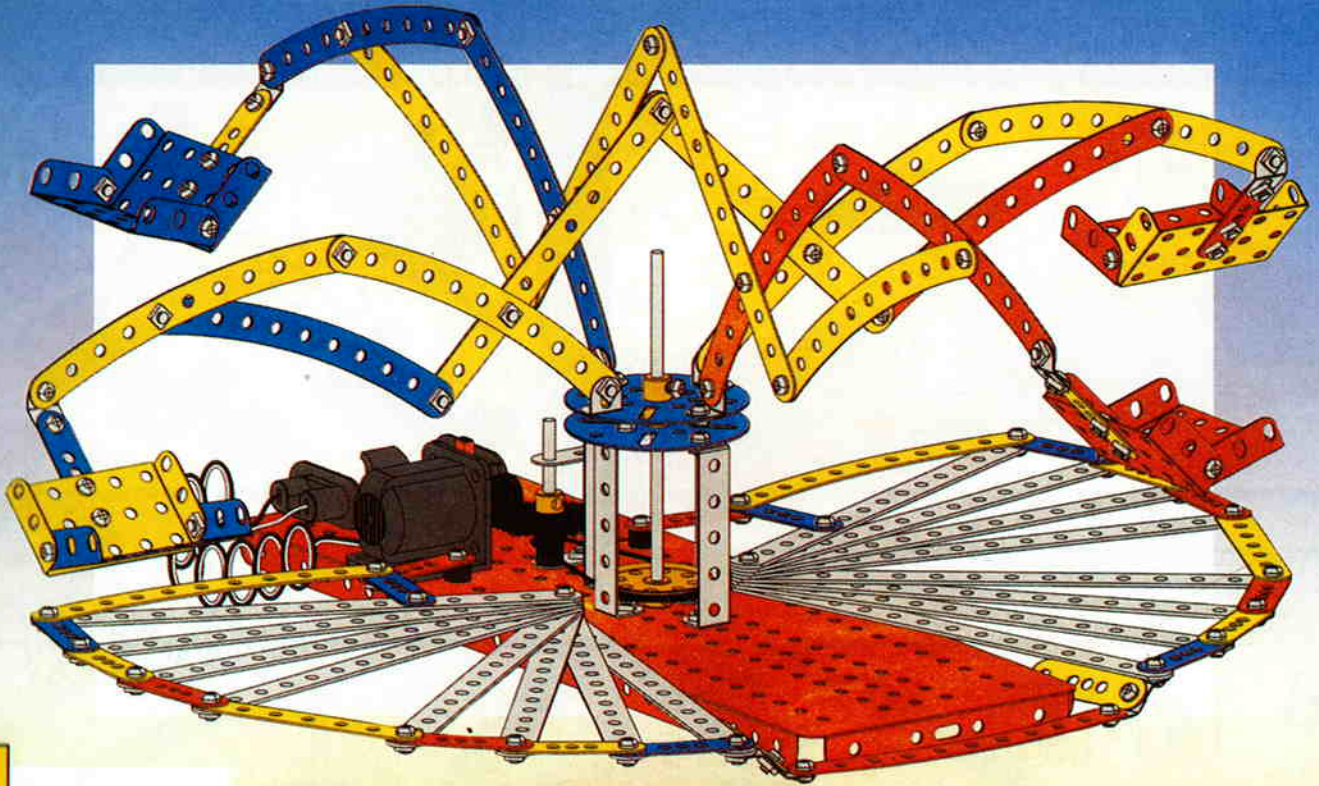

1

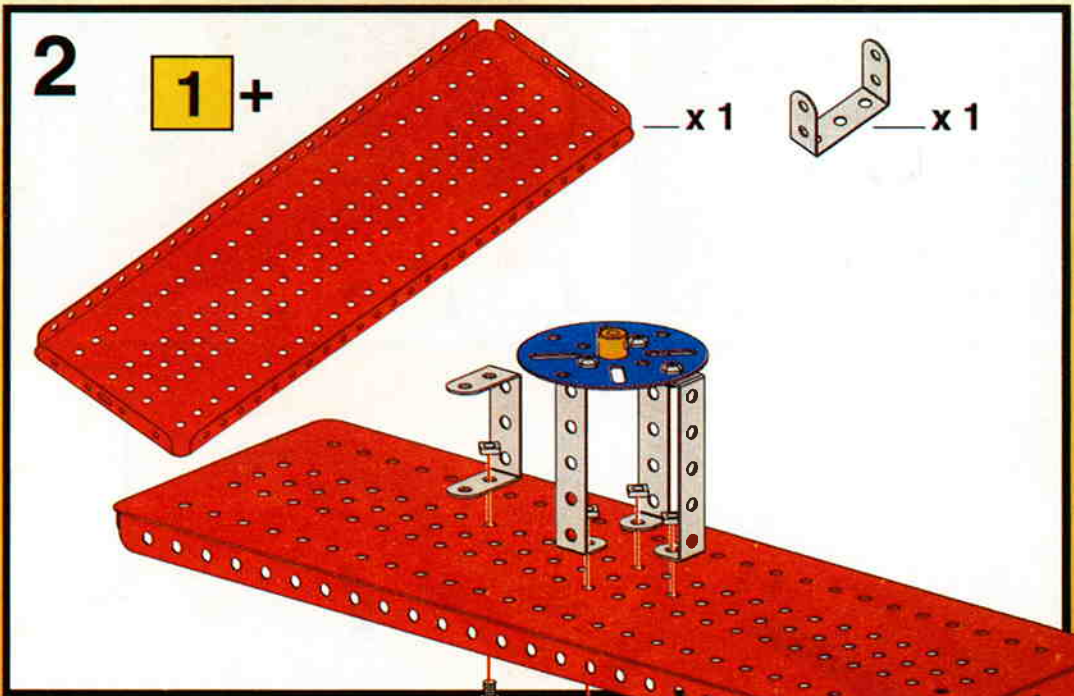
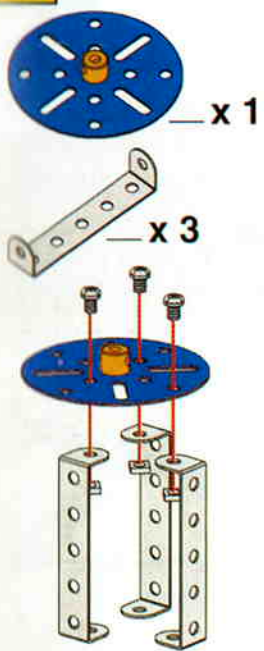

3

2 +

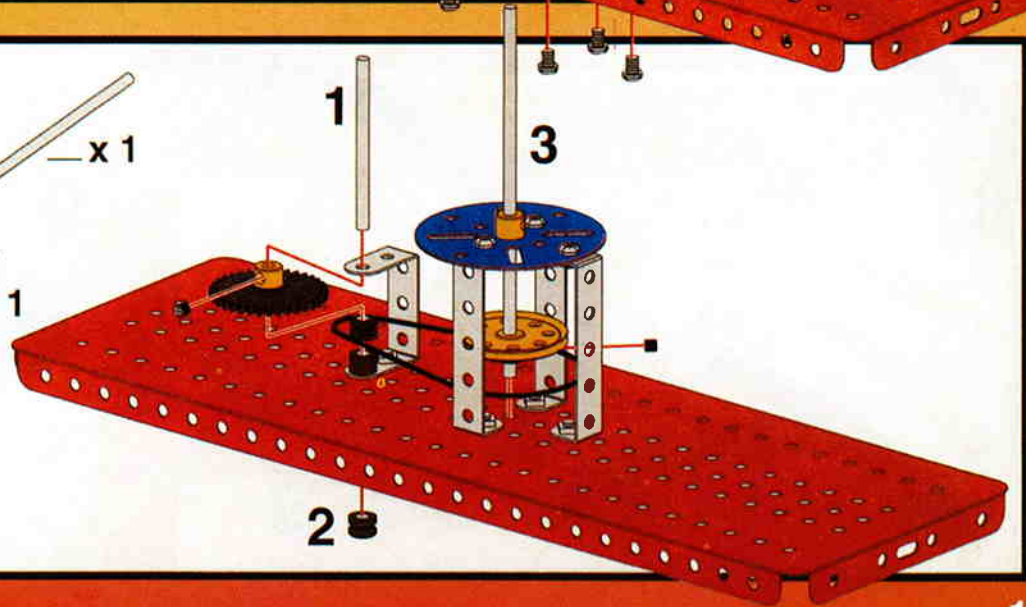
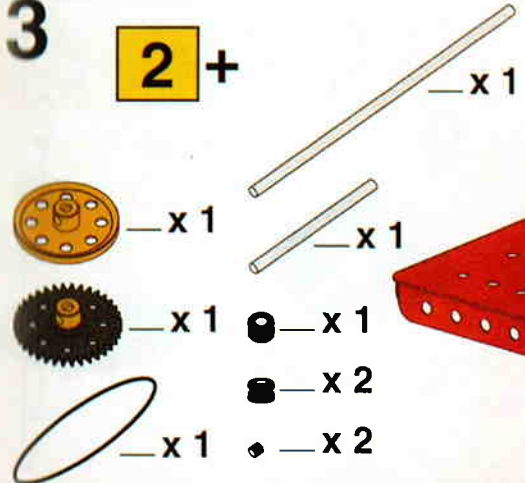

10

7 + 8 + 9

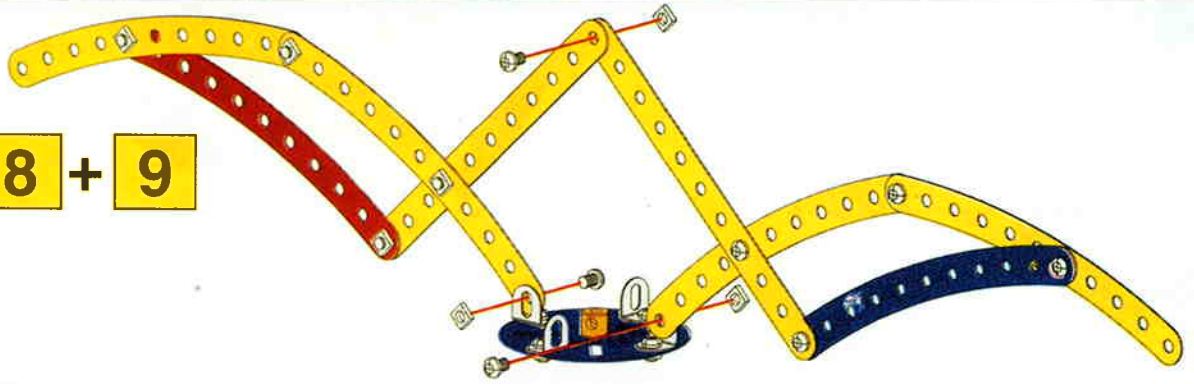

11

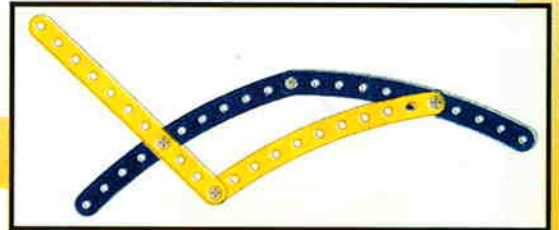
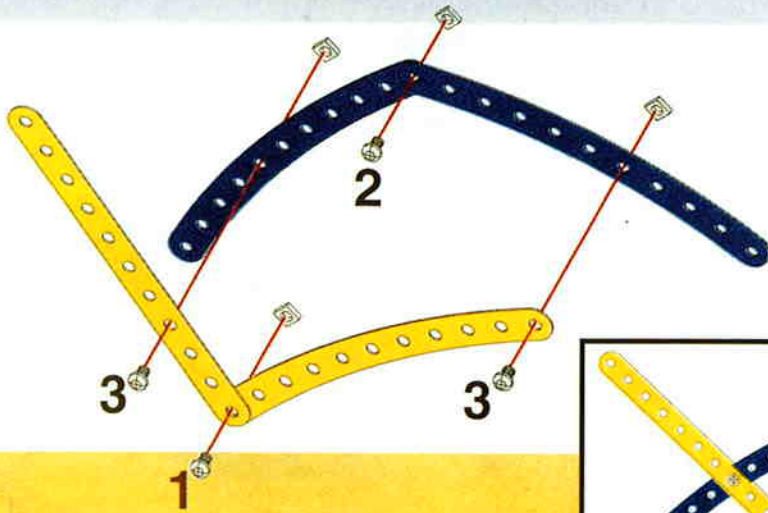
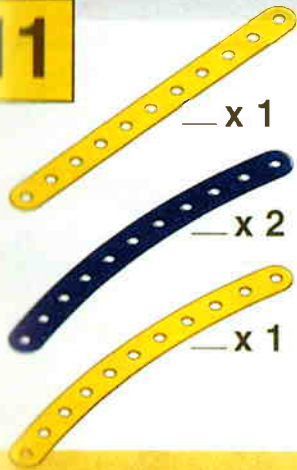

12

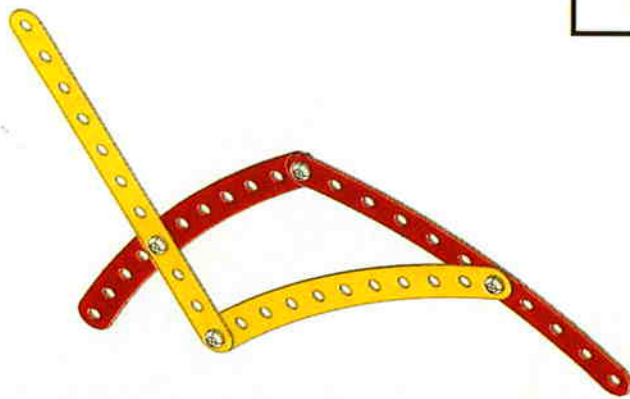
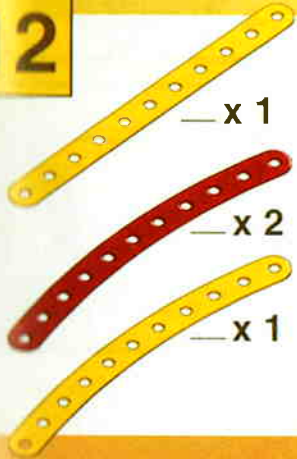

13

10 + 11 + 12

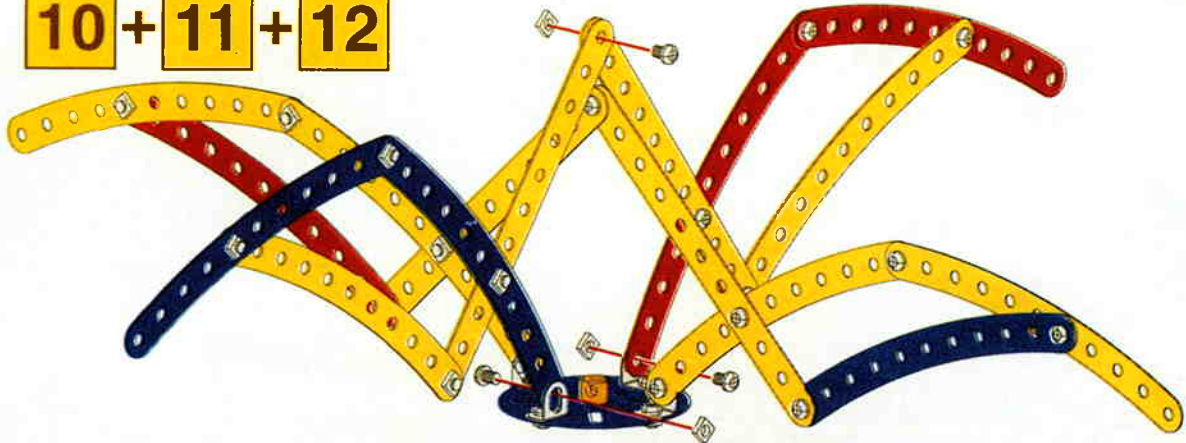

14

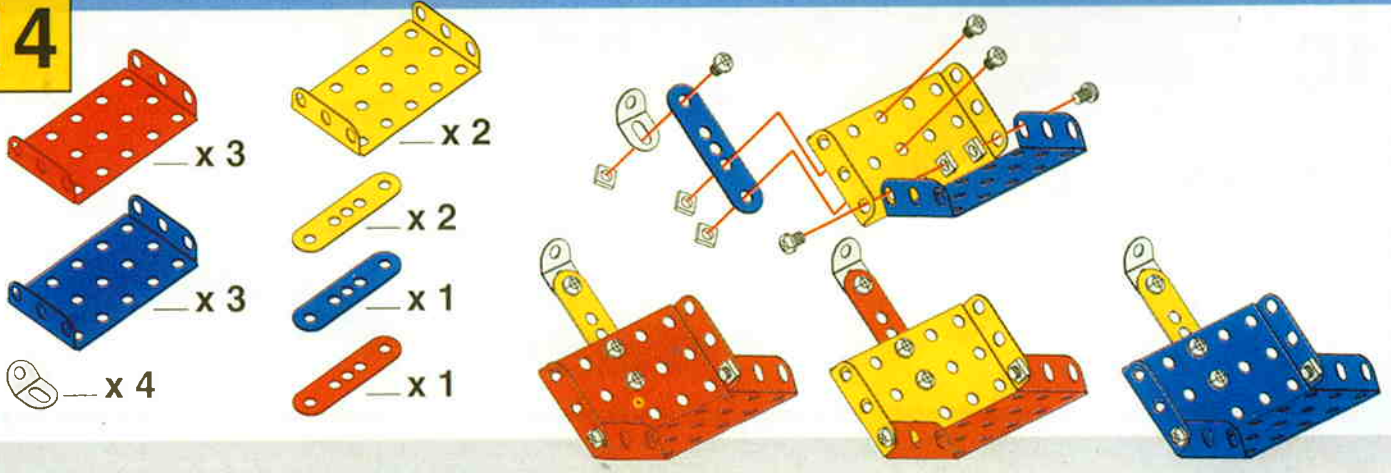

15

13 + 14

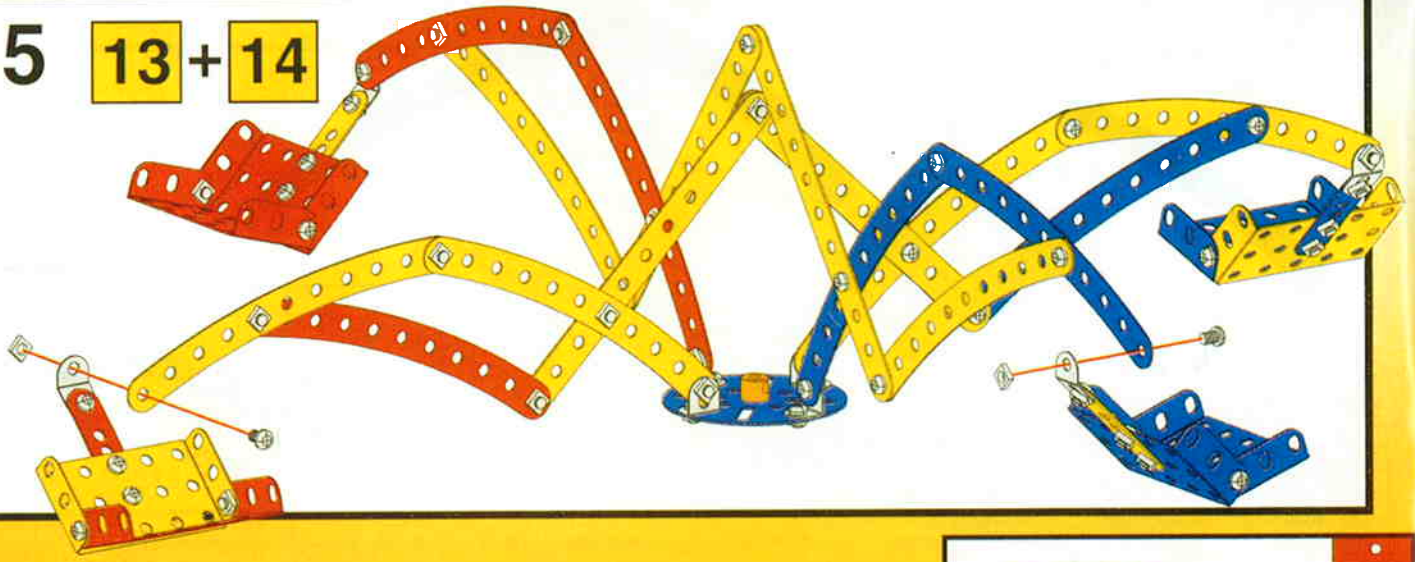

16

6 +

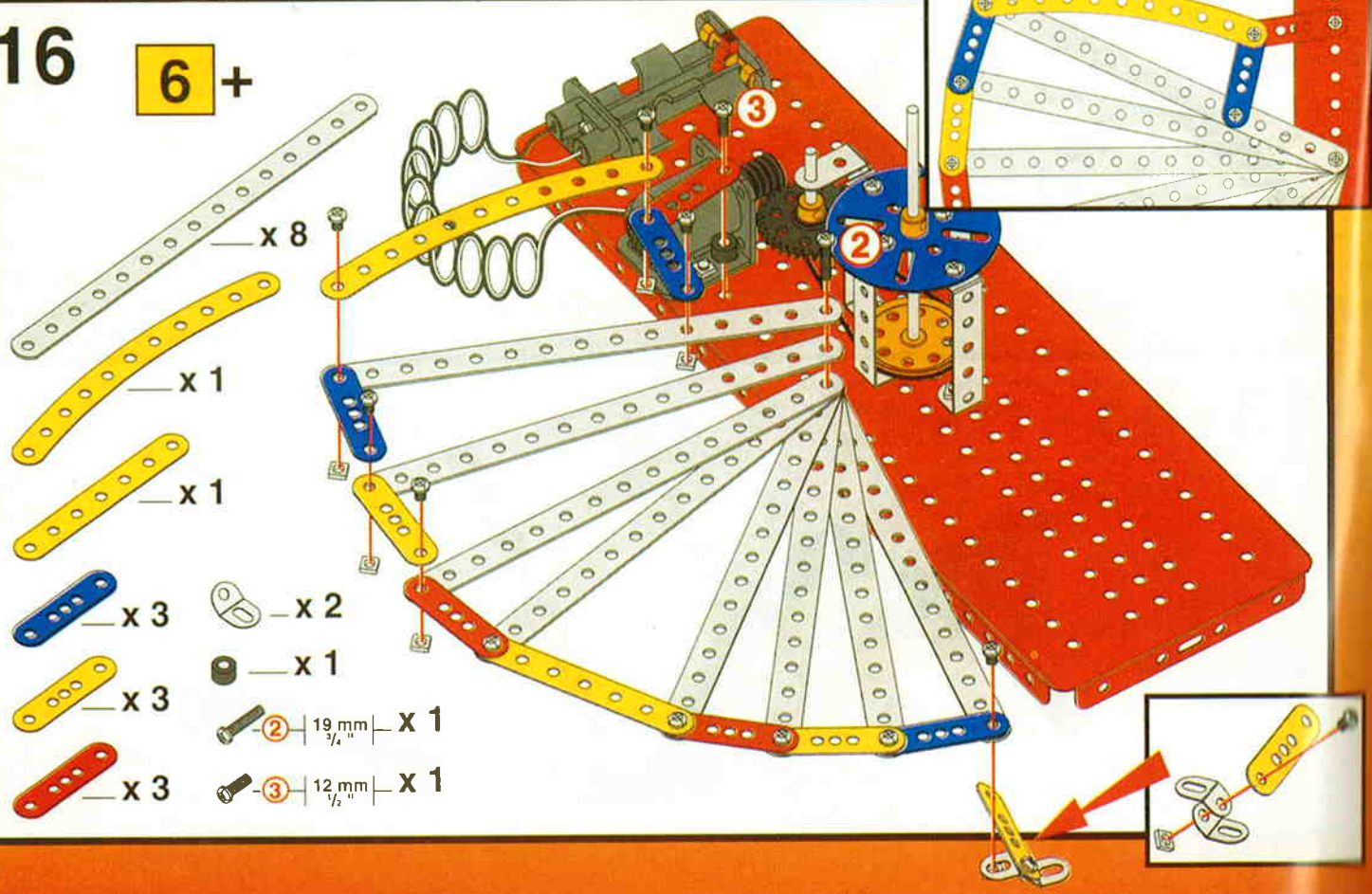

17

16+

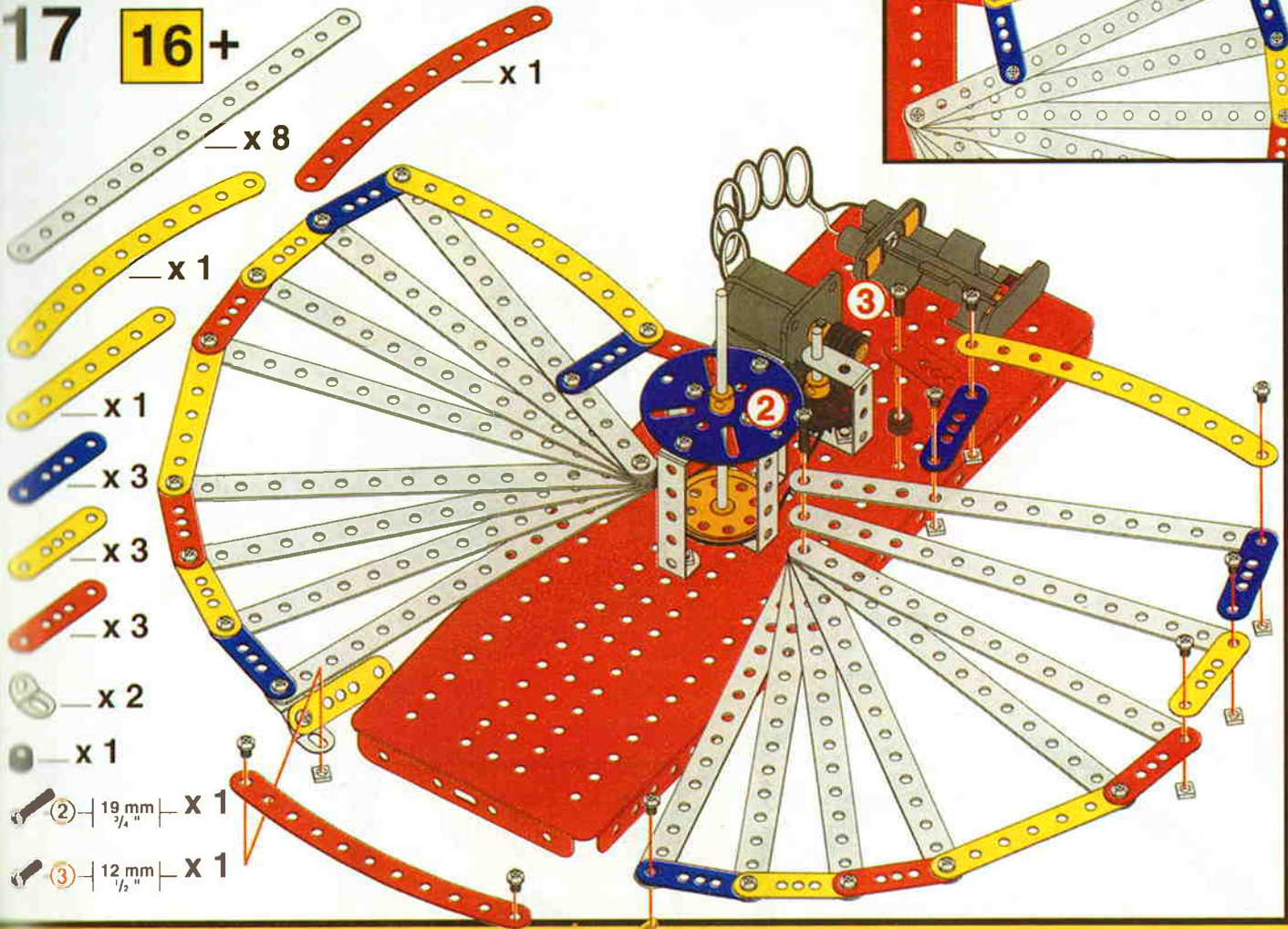

18

15+17

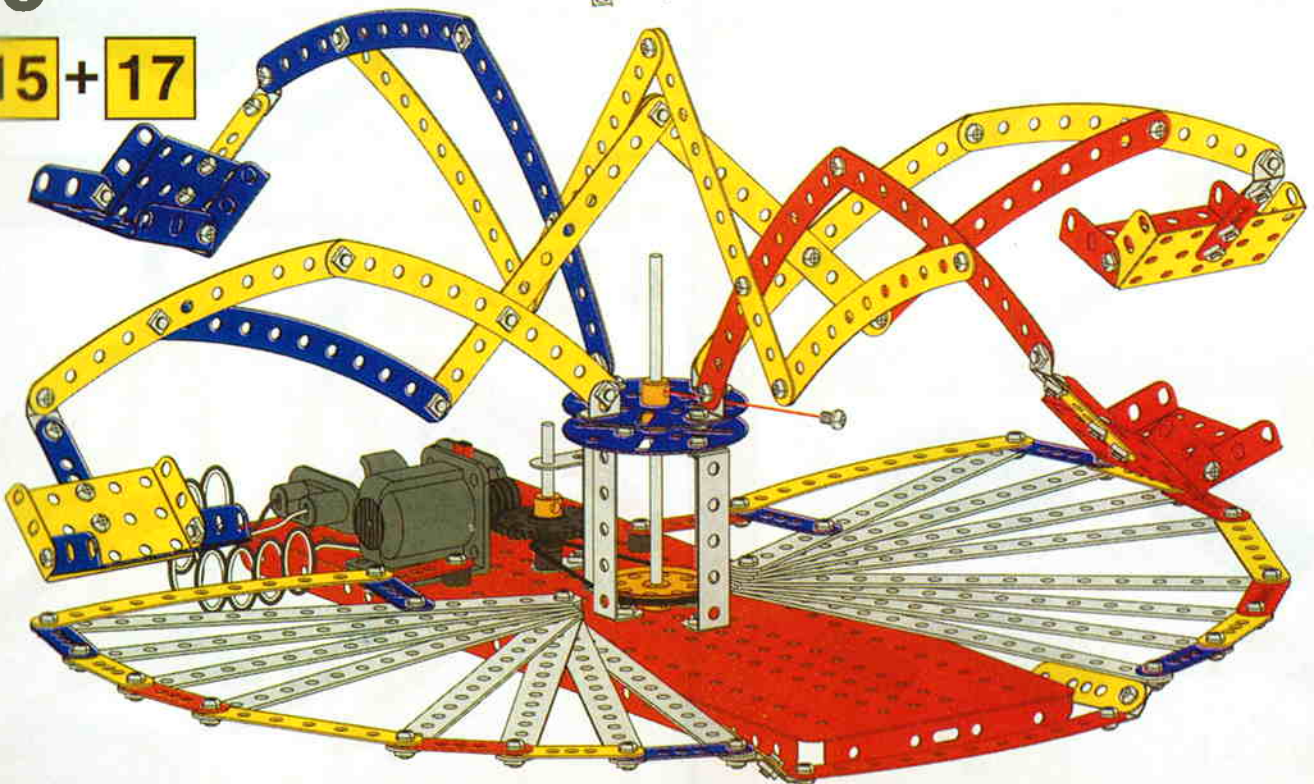

5

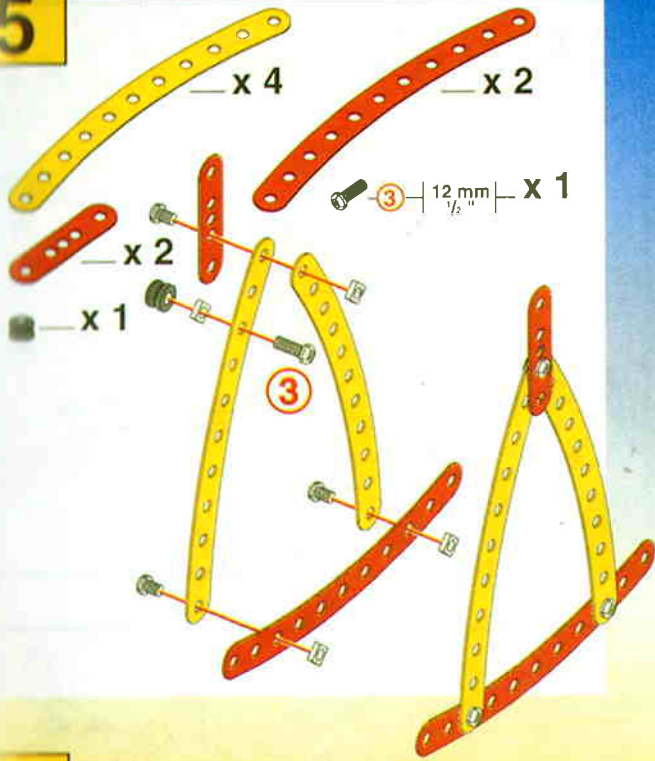

6

5 +

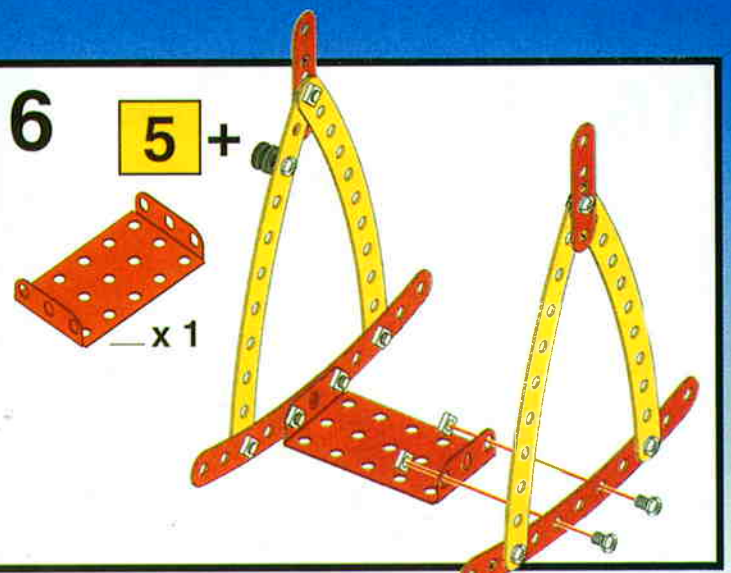

7

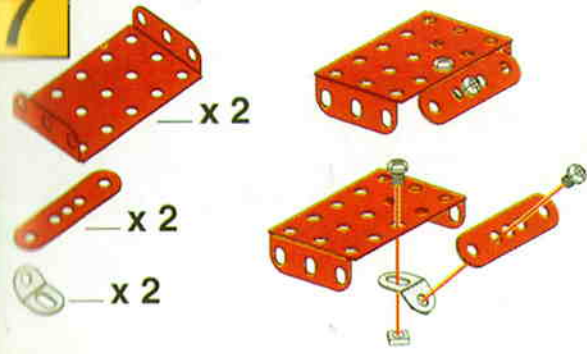

8

6 + 7 +

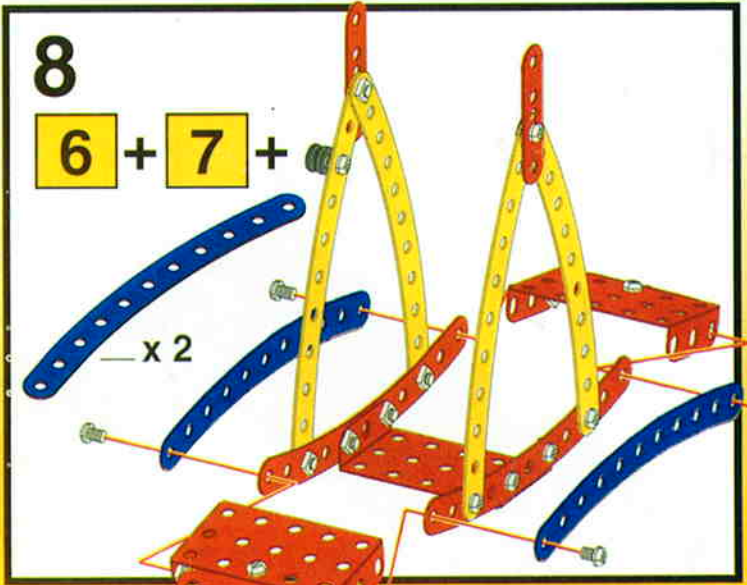

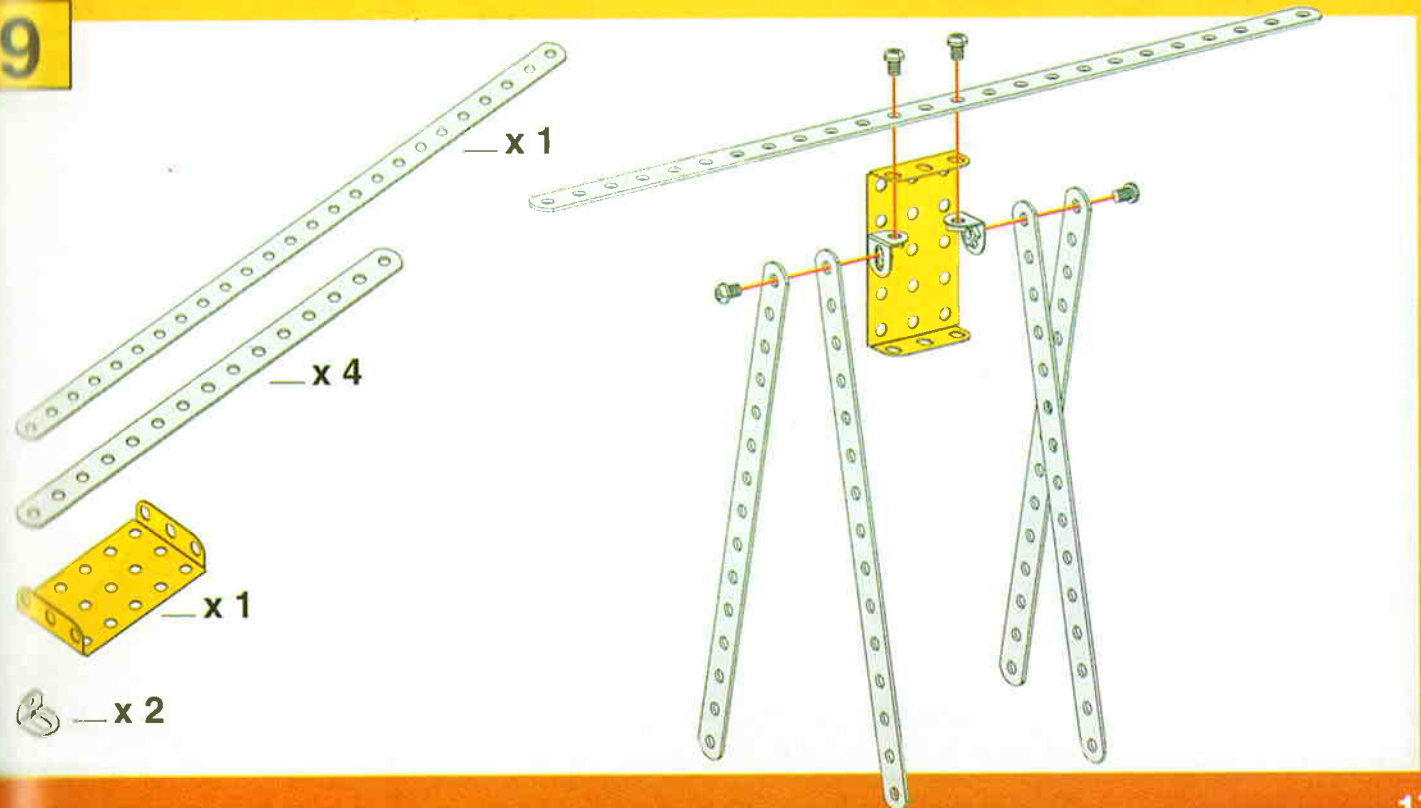

9

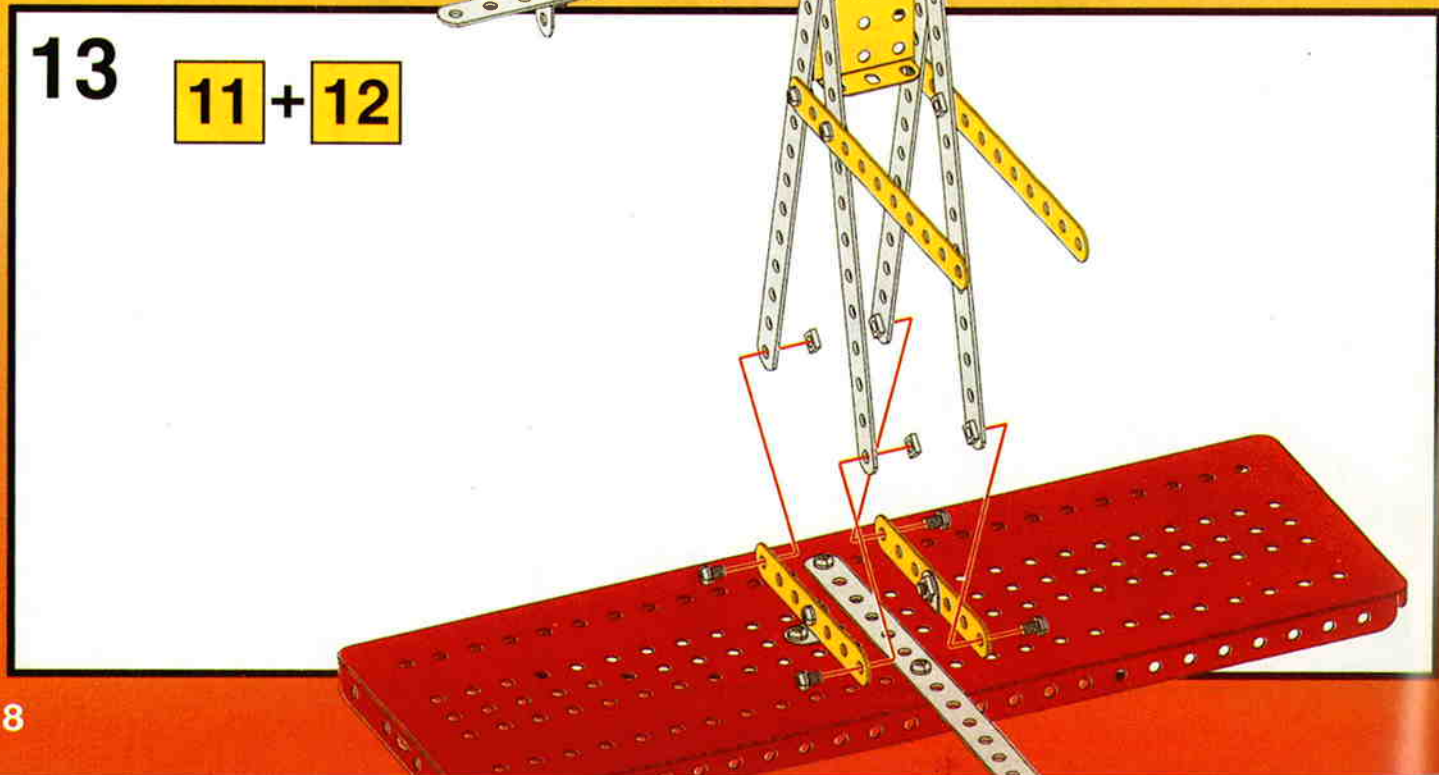
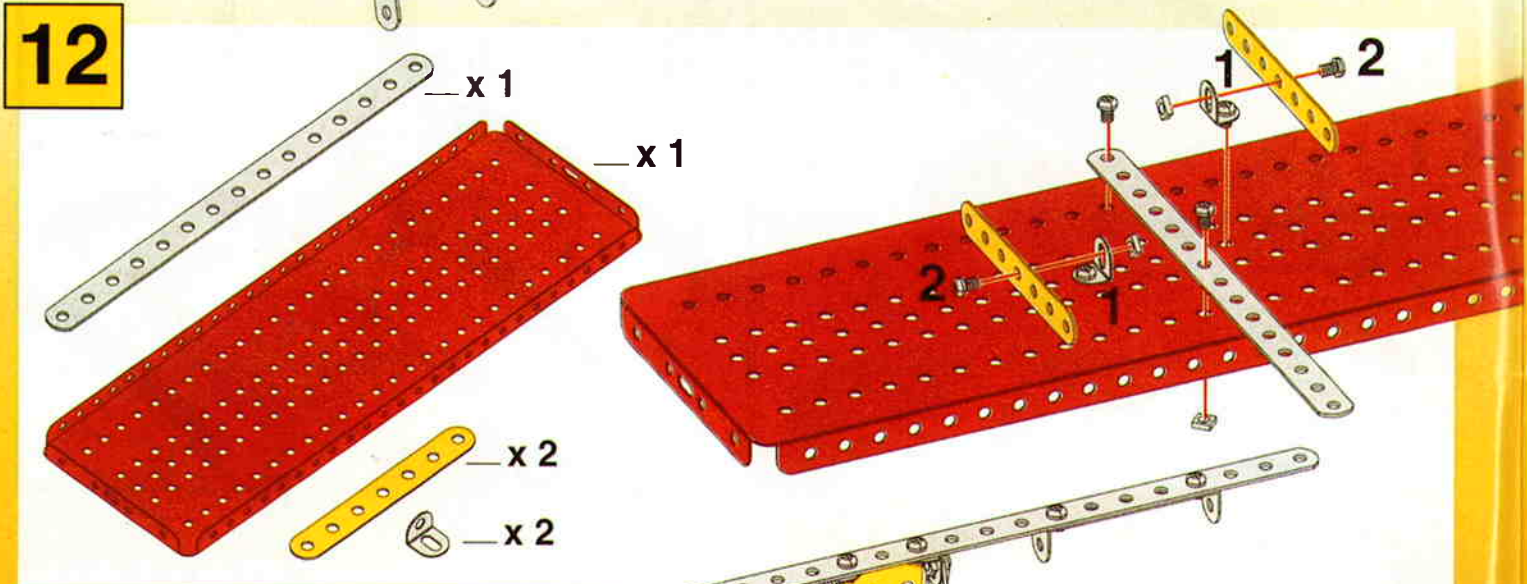
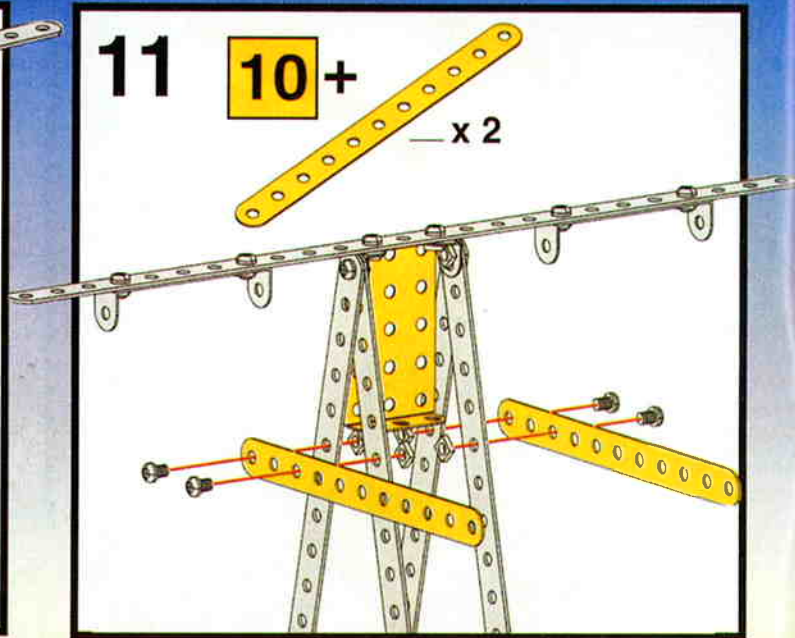
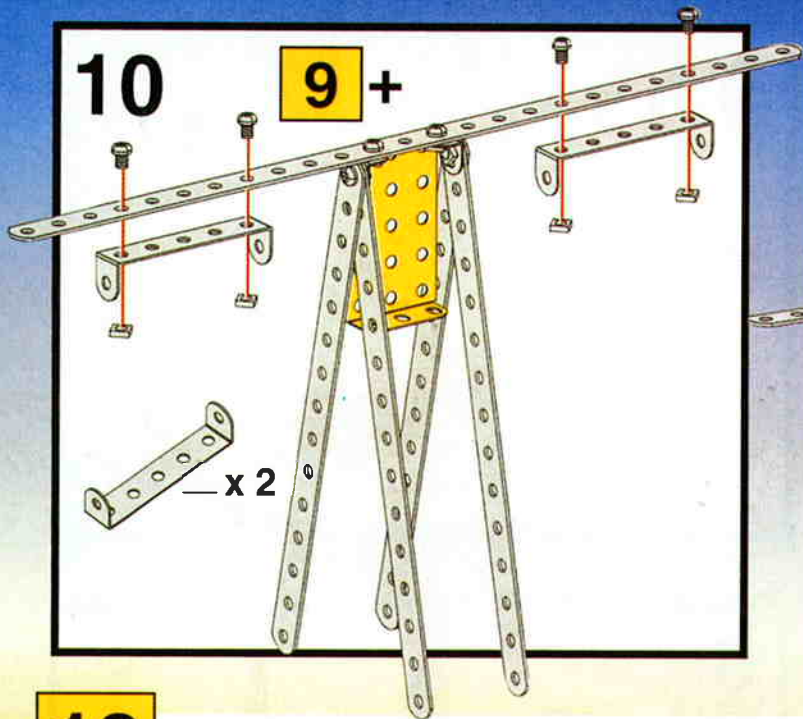



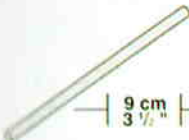



14 **13+**

 — $\frac{9 \text{ cm}}{3 \frac{1}{2}}$ — x 2
 — x 4

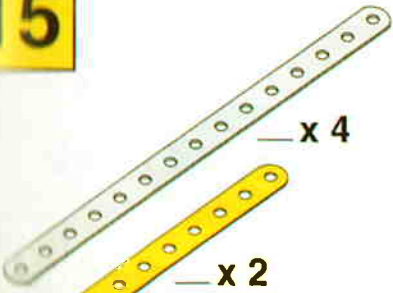
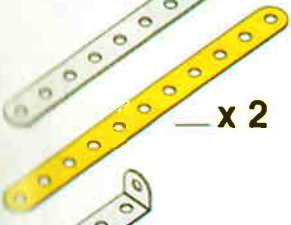
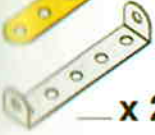

15

 — x 4
 — x 2
 — x 2
 — x 2
 — x 2
 — $\frac{9.5 \text{ mm}}{3/8}$ — x 2

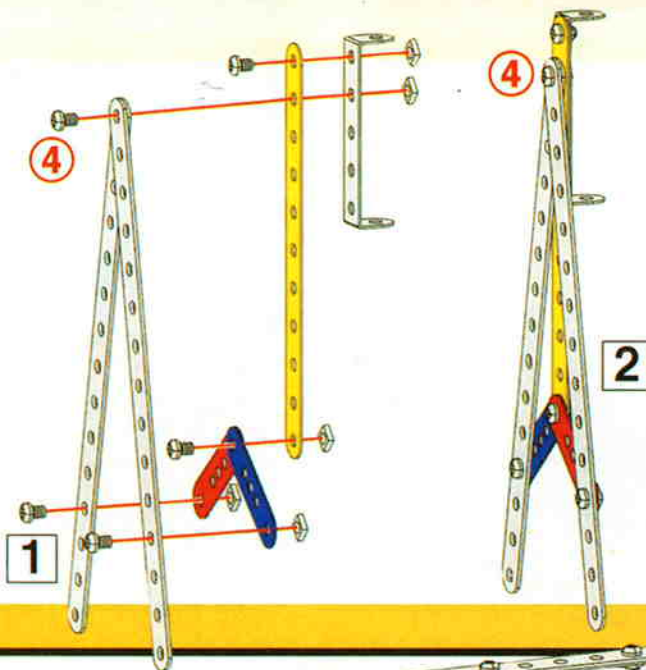

16

14+15

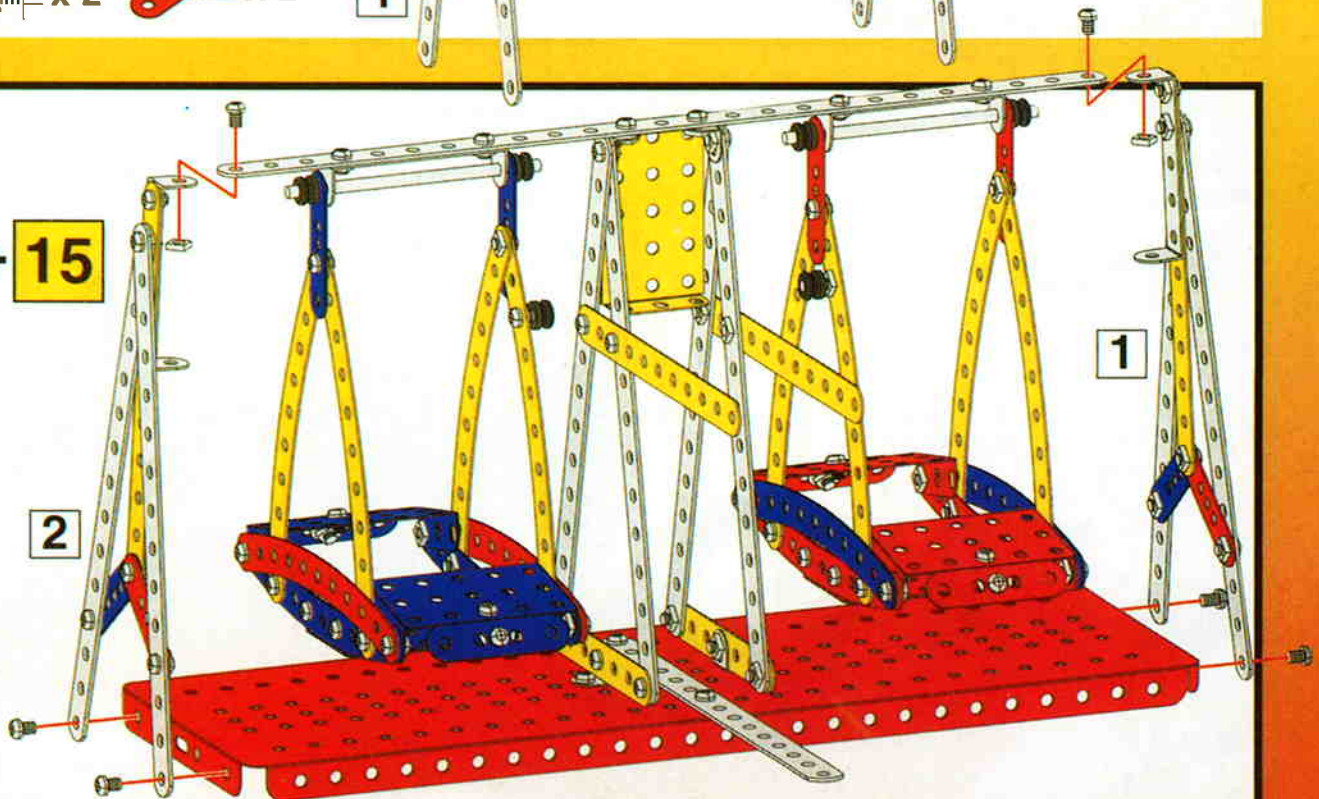

17

- Motor $\times 1$
- Yellow plate $\times 2$
- Spring $\times 1$
- Pin $\times 1$

18

17 +

- Grey bracket $\times 1$
- Grey connector $\times 1$
- Pin (4) $9.5\text{ mm } \frac{3}{8}'' \times 1$
- White plate $\times 1$
- White plate $\times 1$

19

16 + 18

20

- Pin $\times 2$
- Blue wheel $\times 2$
- Pin (3) $12\text{ mm } \frac{1}{2}'' \times 2$

21

19 + 20 +

- Beam $9\text{ cm } \frac{3\frac{1}{2}''}{\times 1}$
- White ring $\times 2$
- Black gear $\times 1$
- Pin $\times 2$
- Pin $\times 7$
- Pin $\times 1$

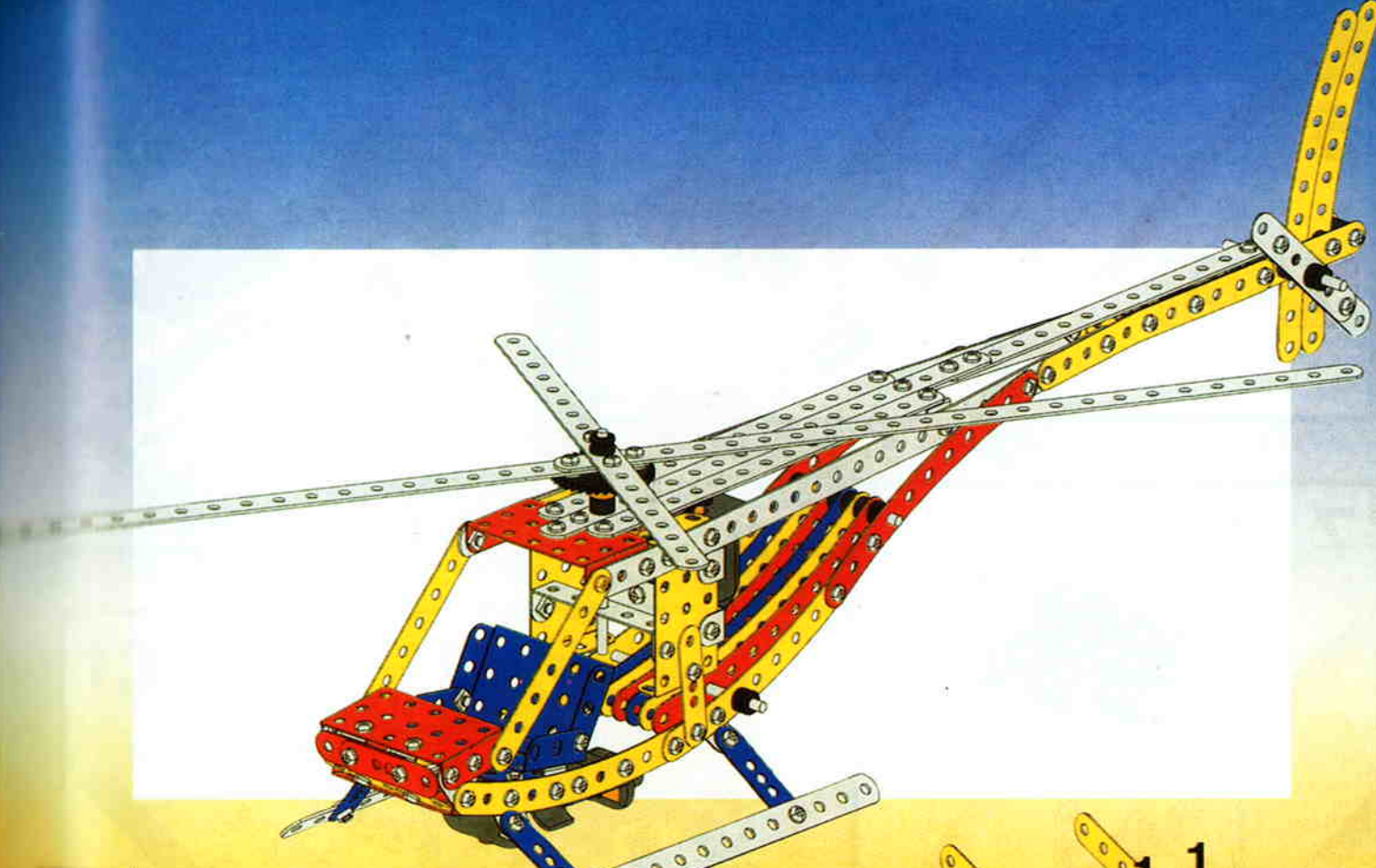

1

- x 1
- x 2
- x 2

2 **1** +

- x 2
- x 2
- x 2
- x 2

3

- x 4
- x 2

4 **3** +

- x 2
- x 4
- x 1

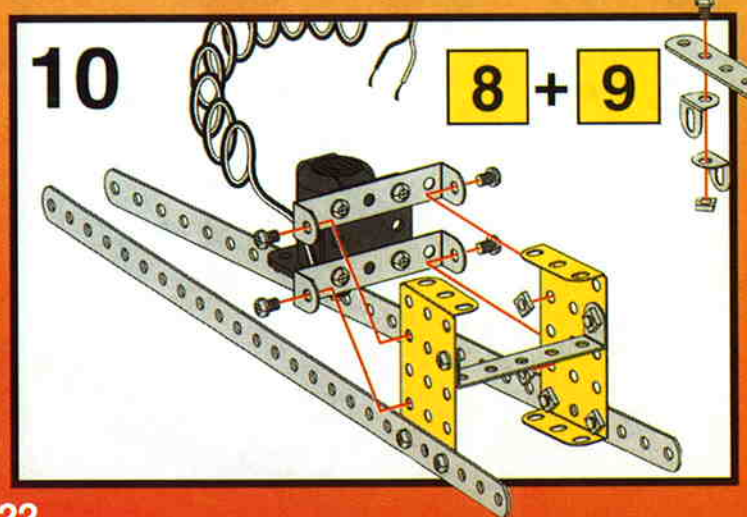
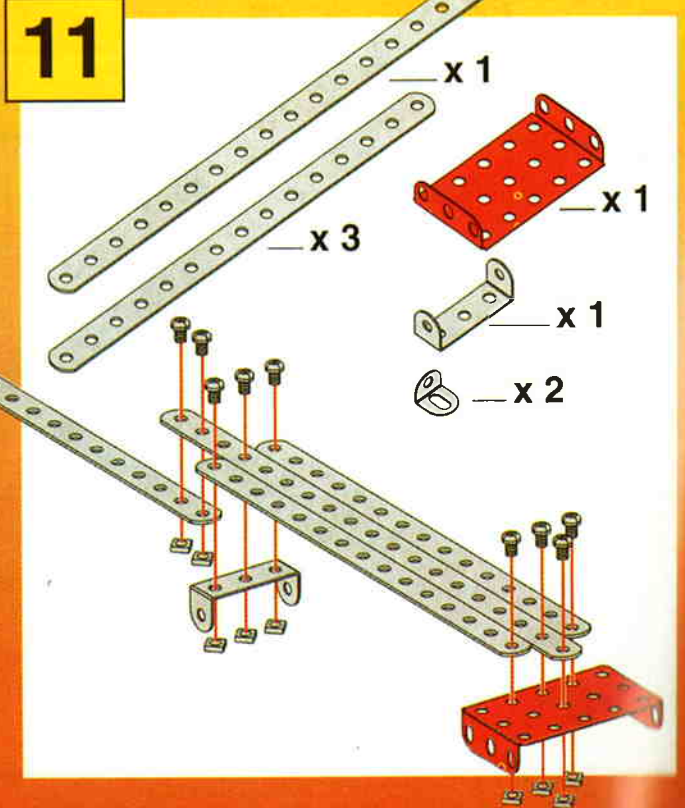
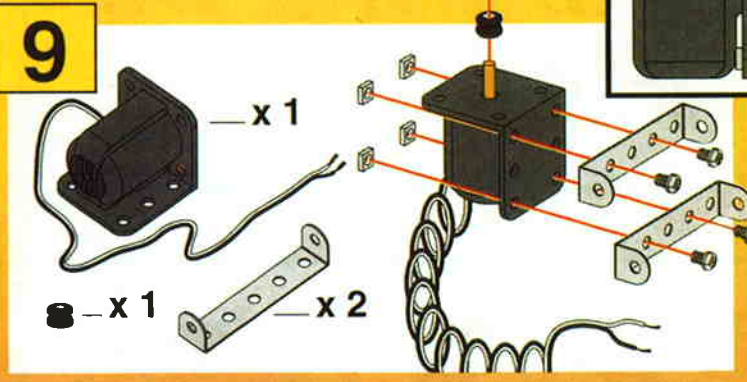
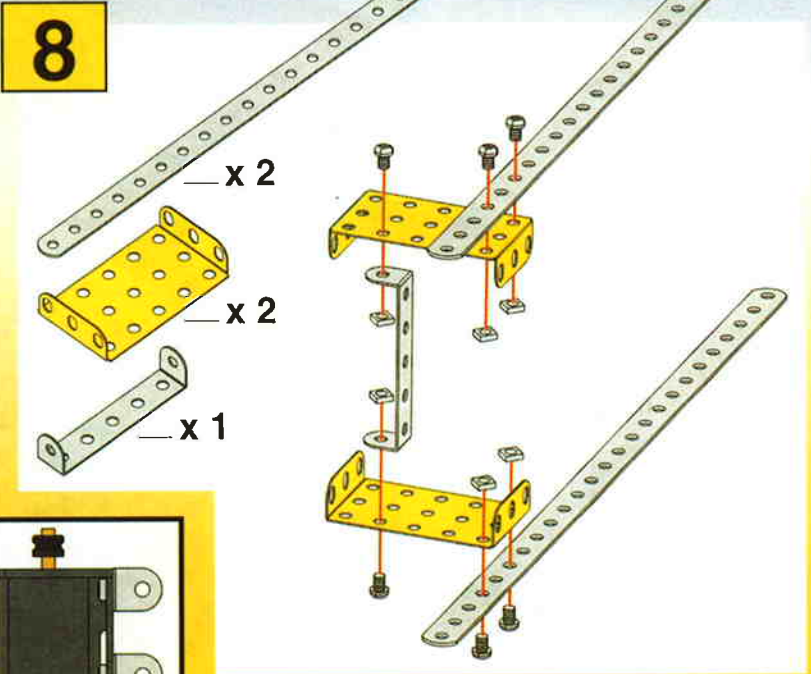
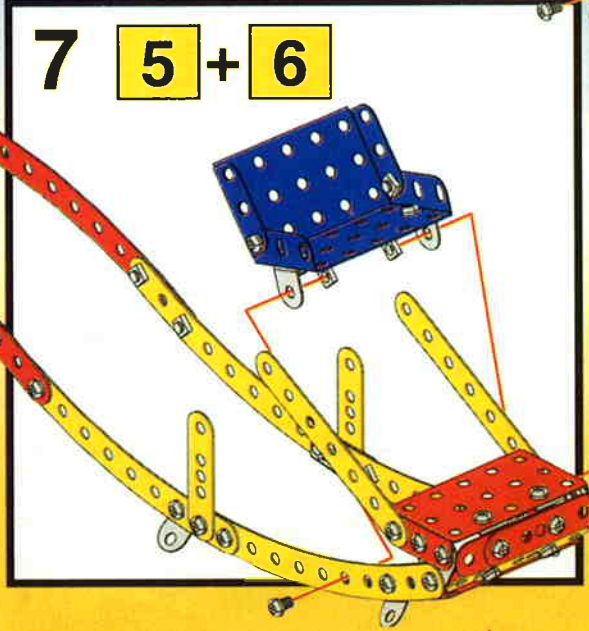
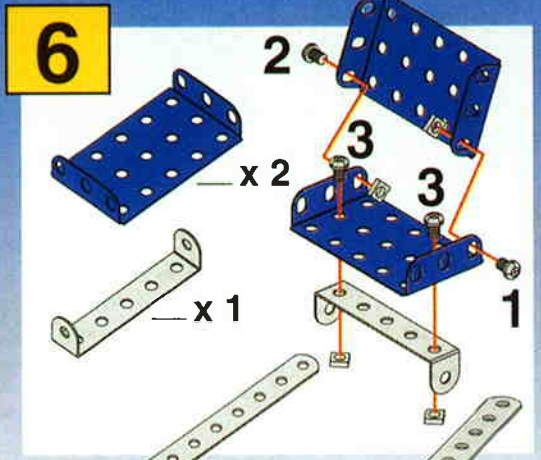
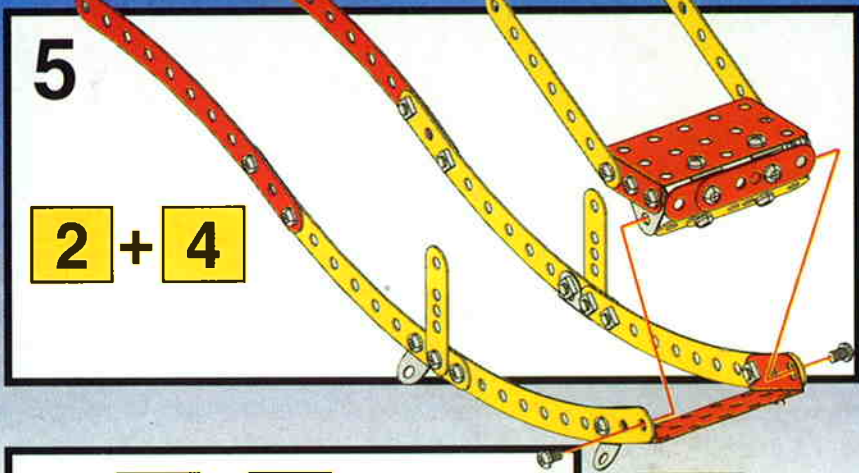

16

14 + **15** +



● X 2

3

2

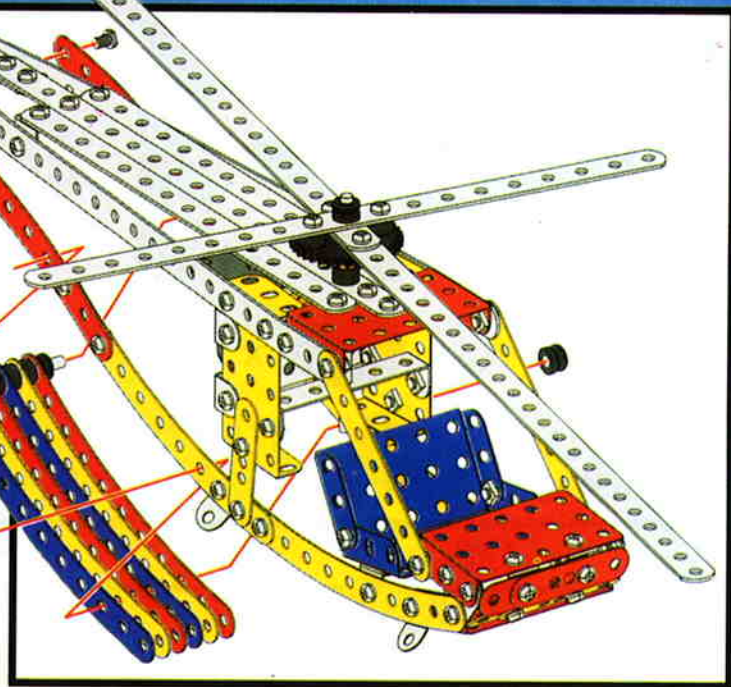

17

1

X 2

X 4

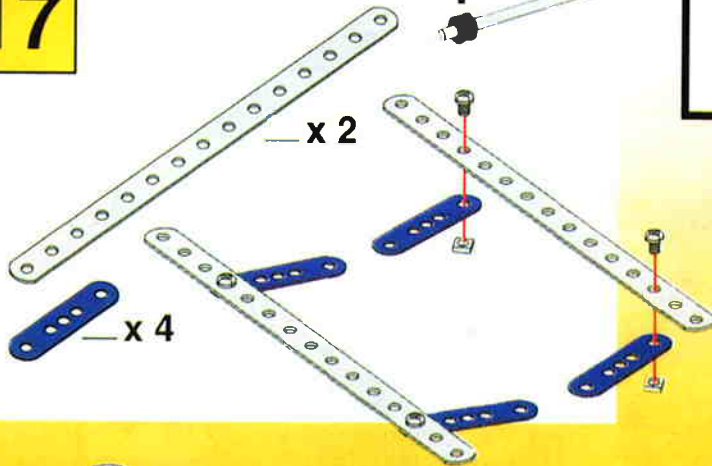

18

X 1

X 1

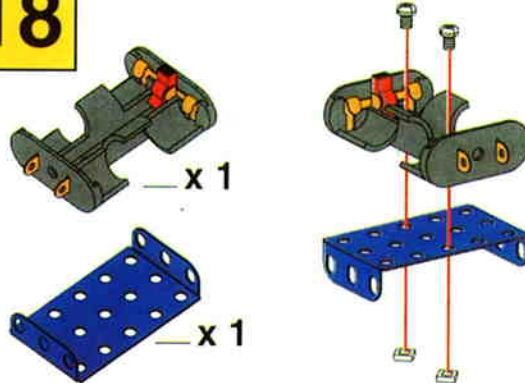

19

16 + **17** + **18**

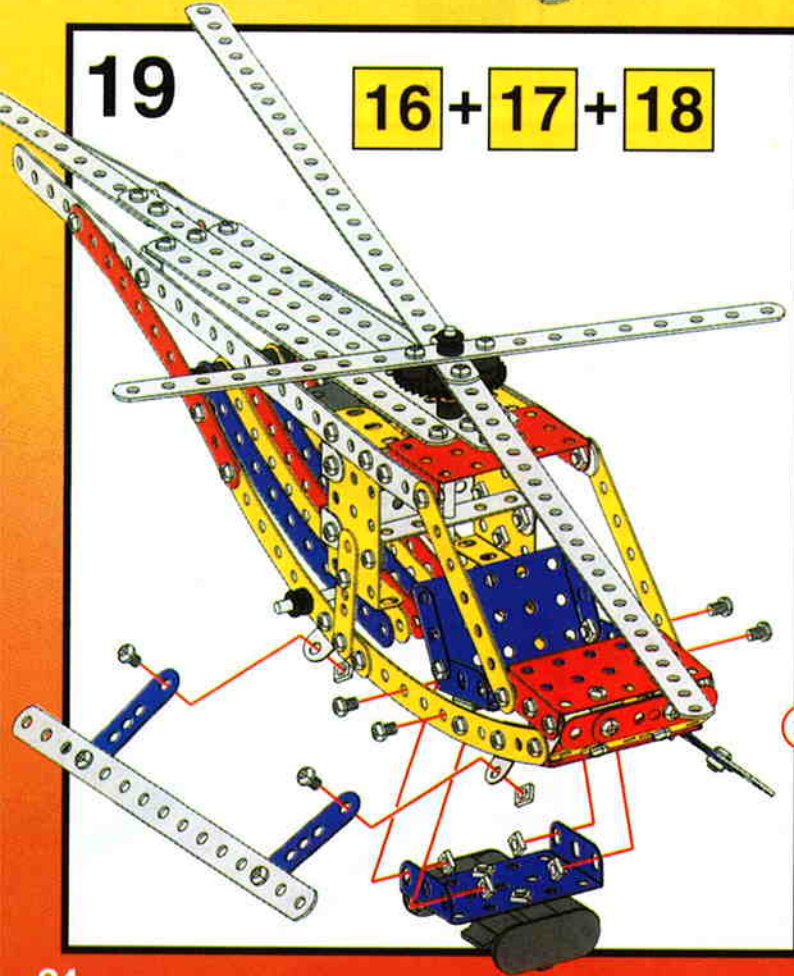

20

X 4

X 2

● (3) | 12 mm | X 2

● X 2

(3)

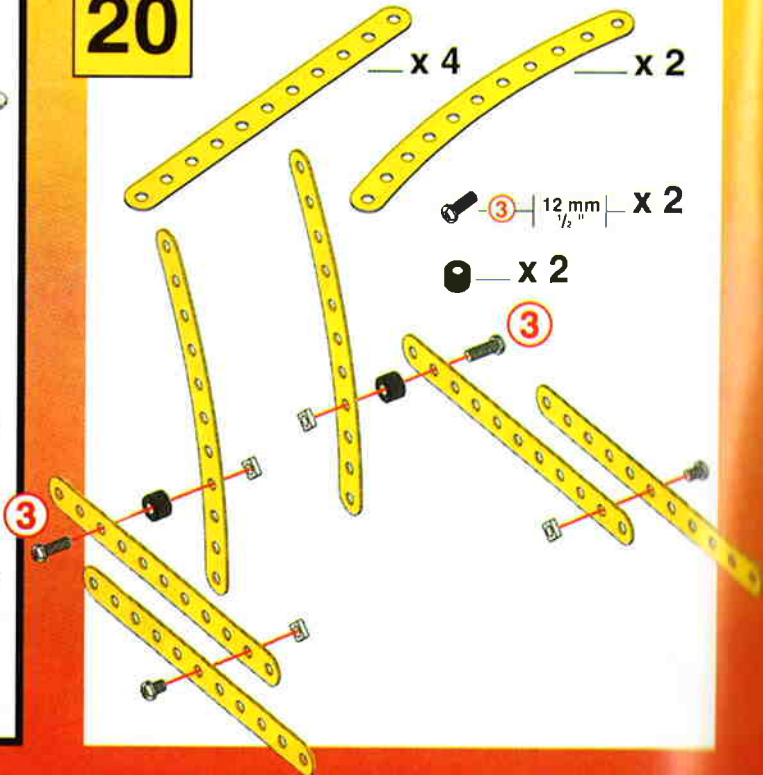

21 19+20+

② — 19 mm — x 2

● — x 4

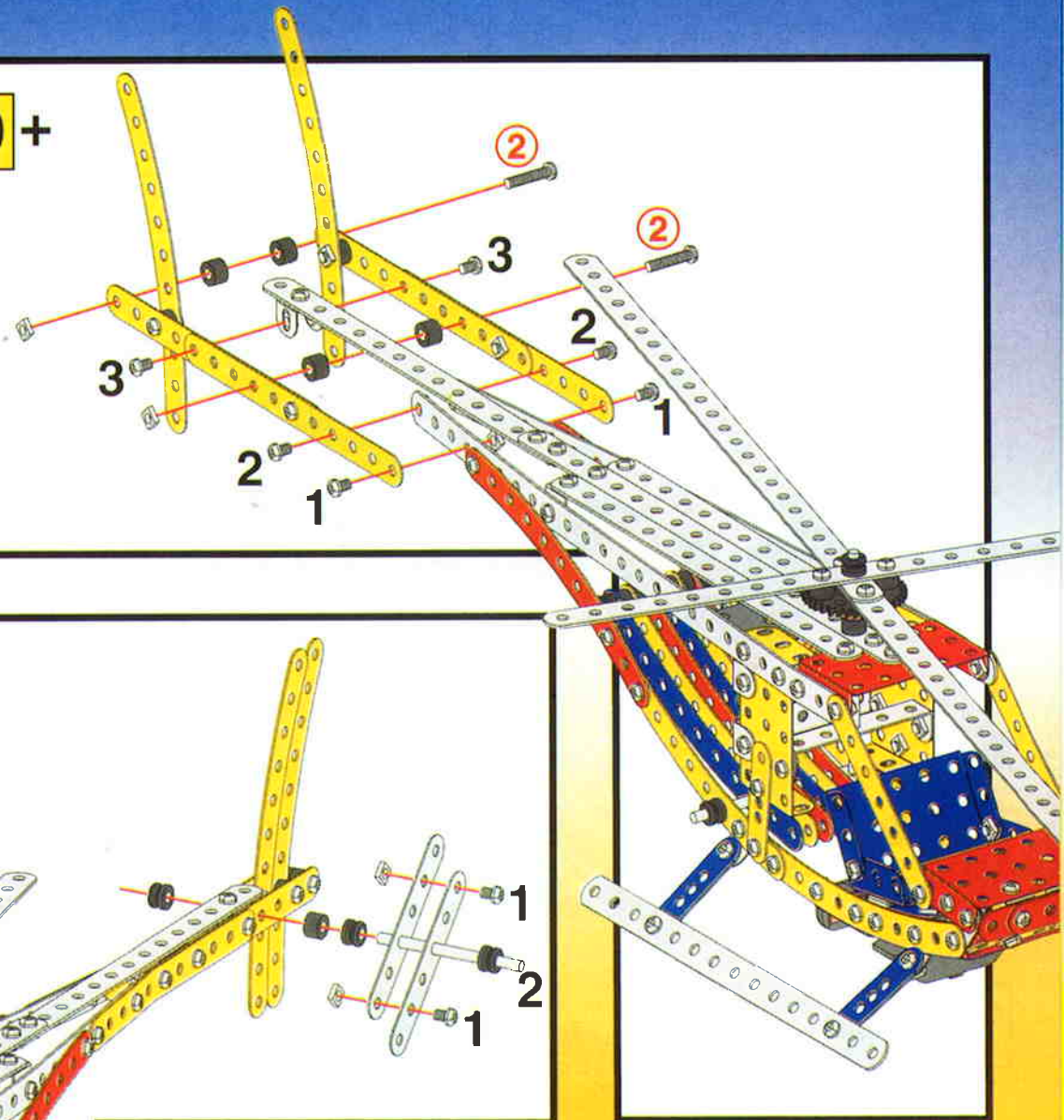

22 21+

— x 2

6 cm — 2 1/2" — x 1

● — x 1

● — x 3

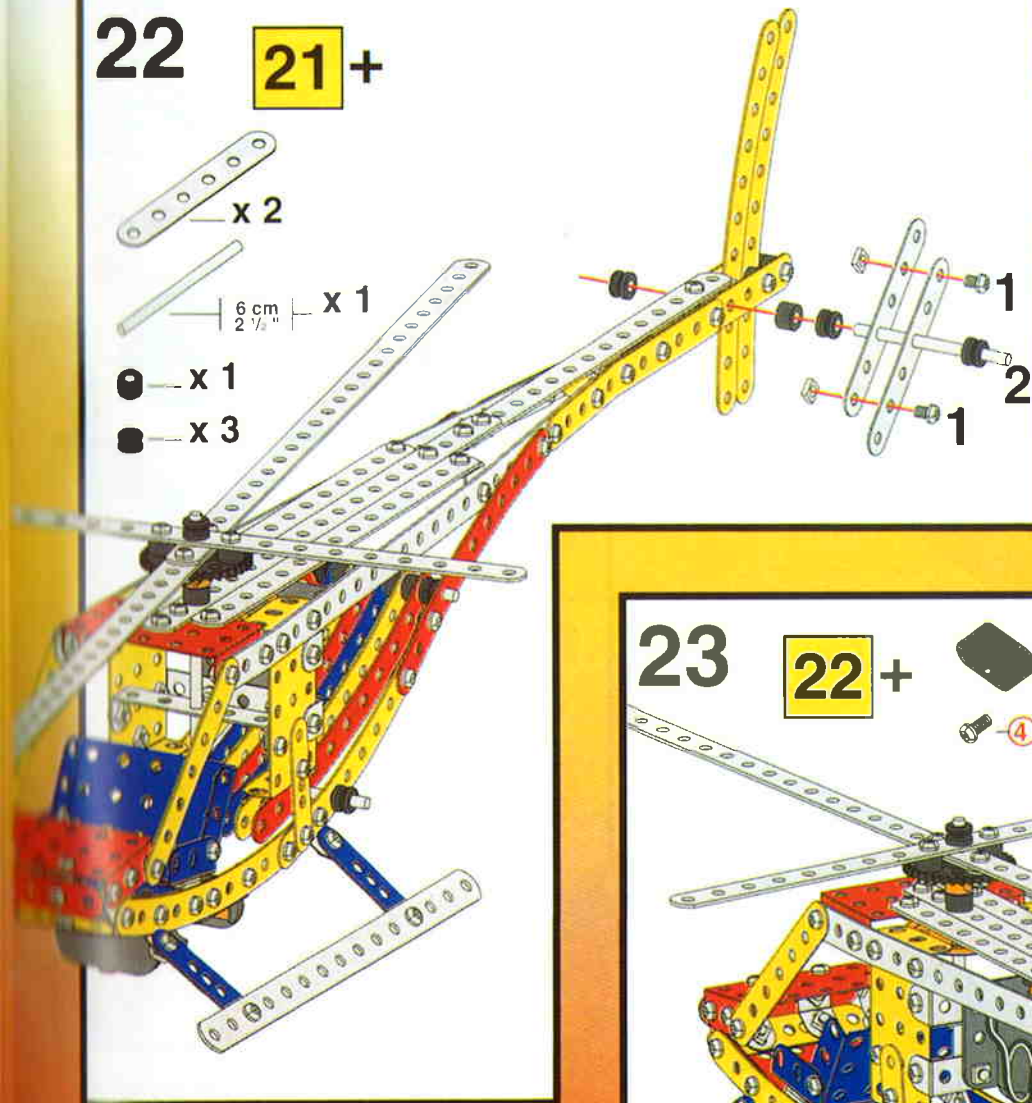

23 22+

— x 1

④ — 9.5 mm — x 1

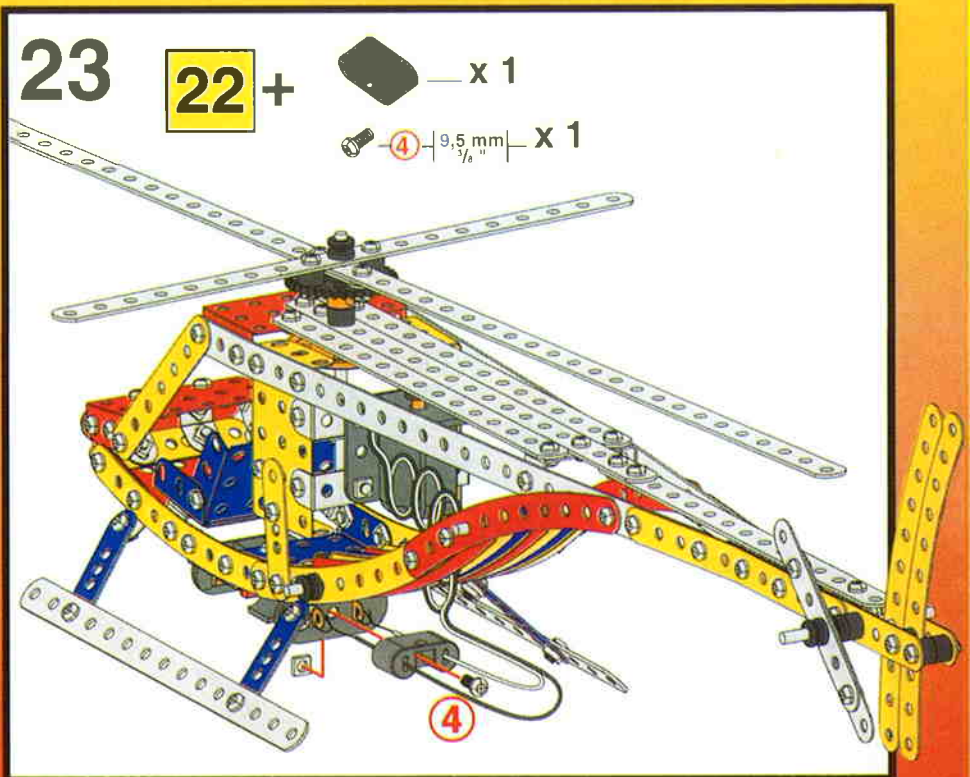

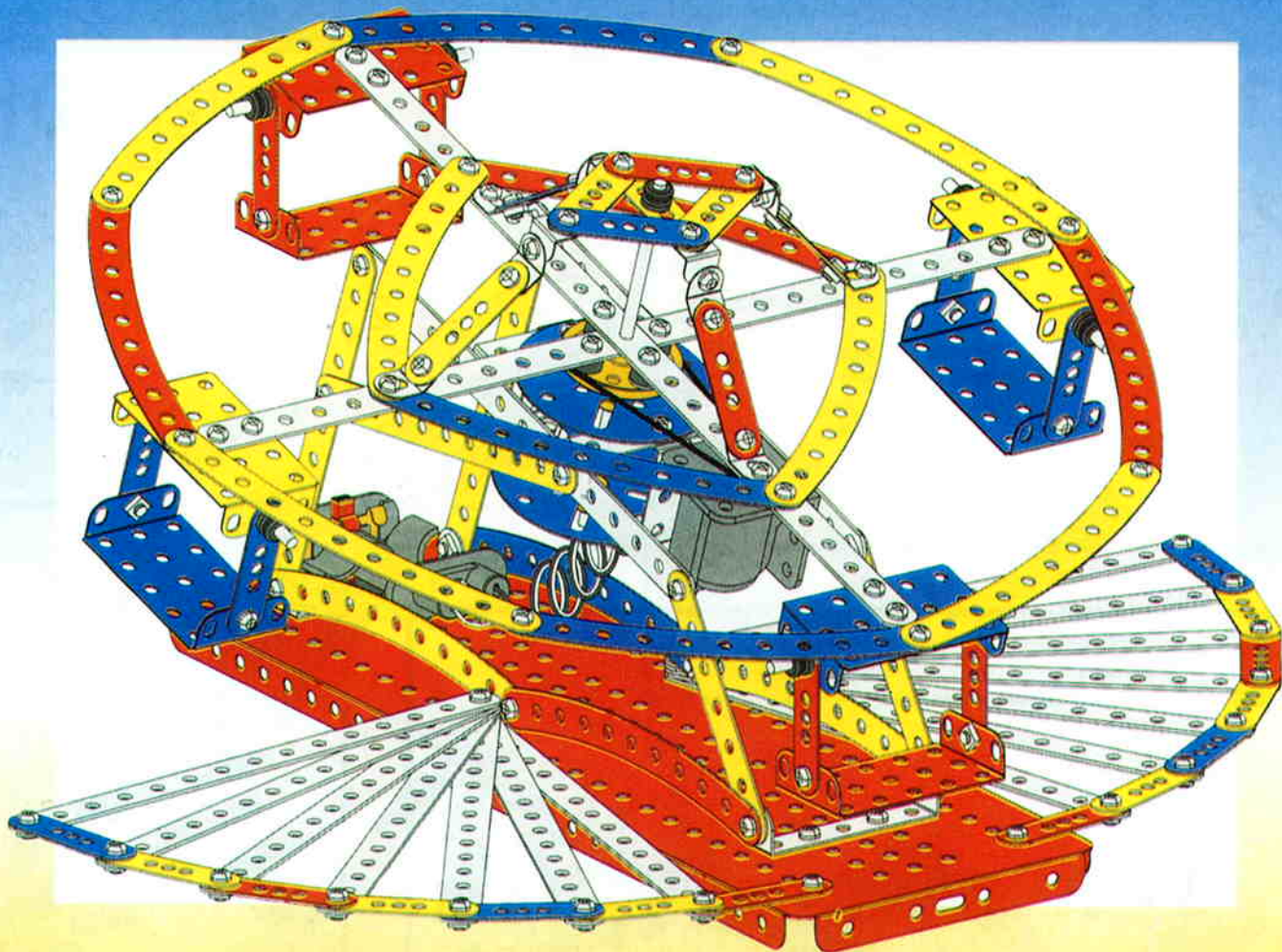



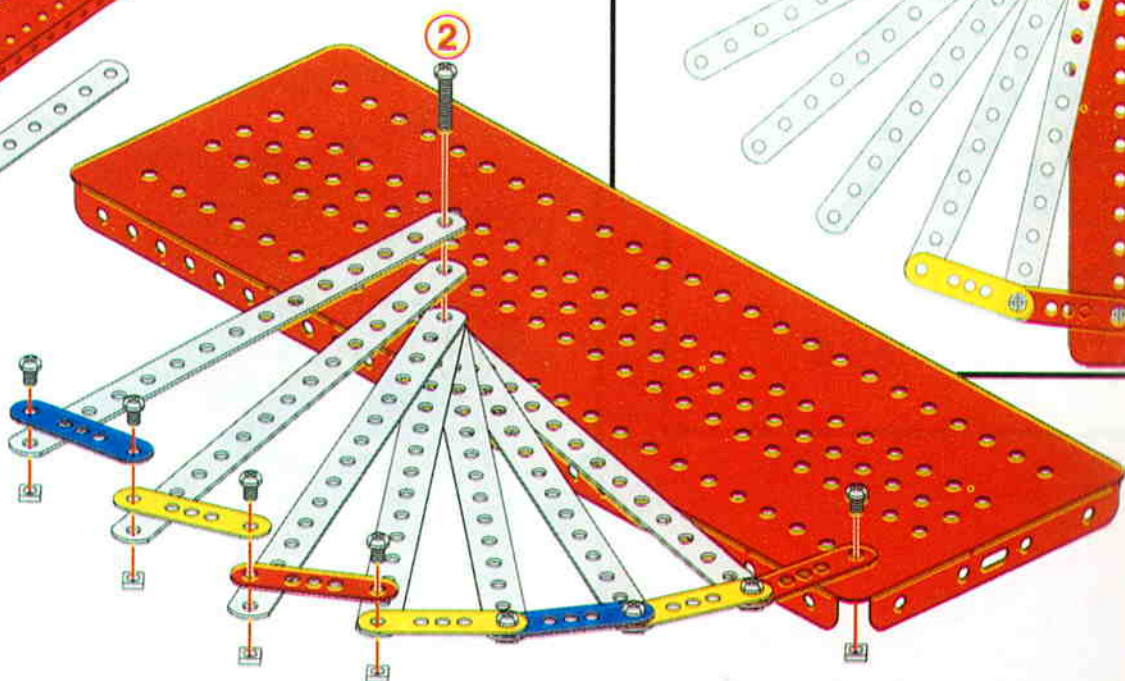
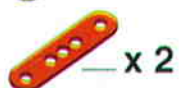
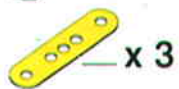
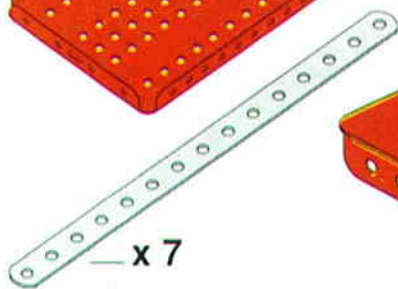
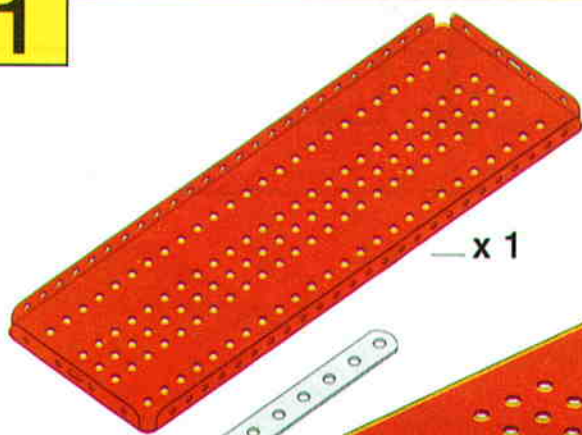

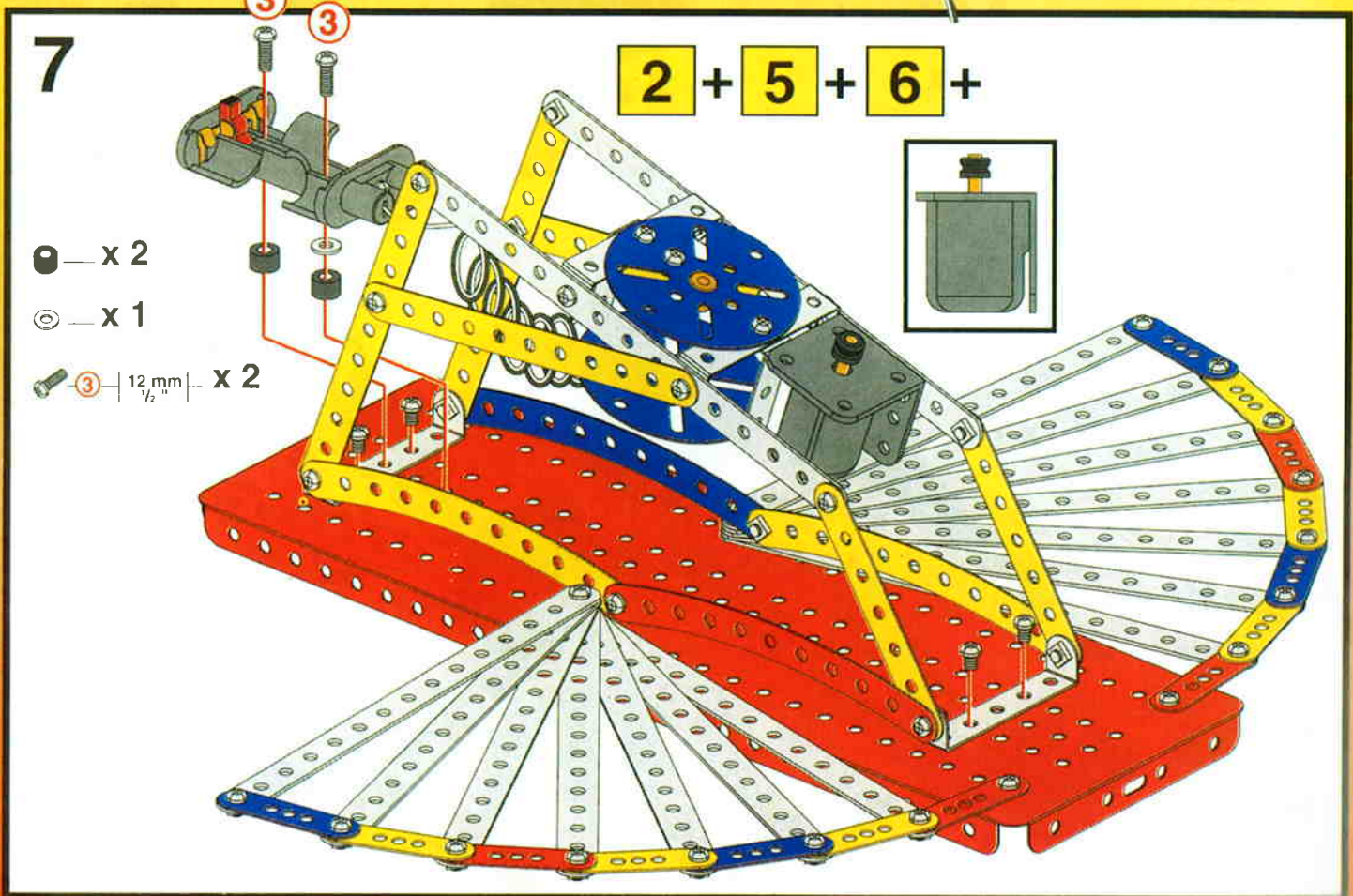
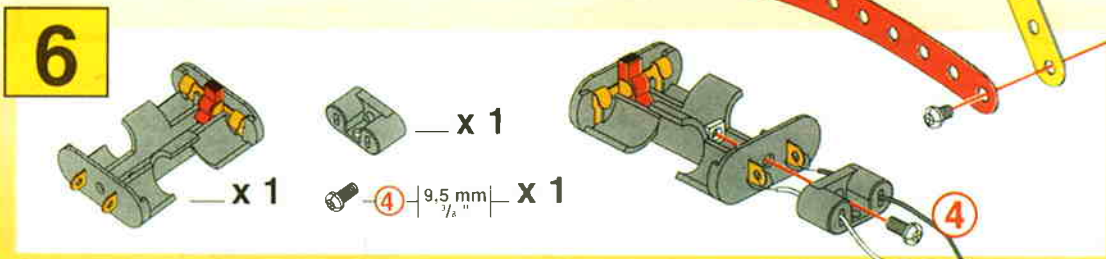
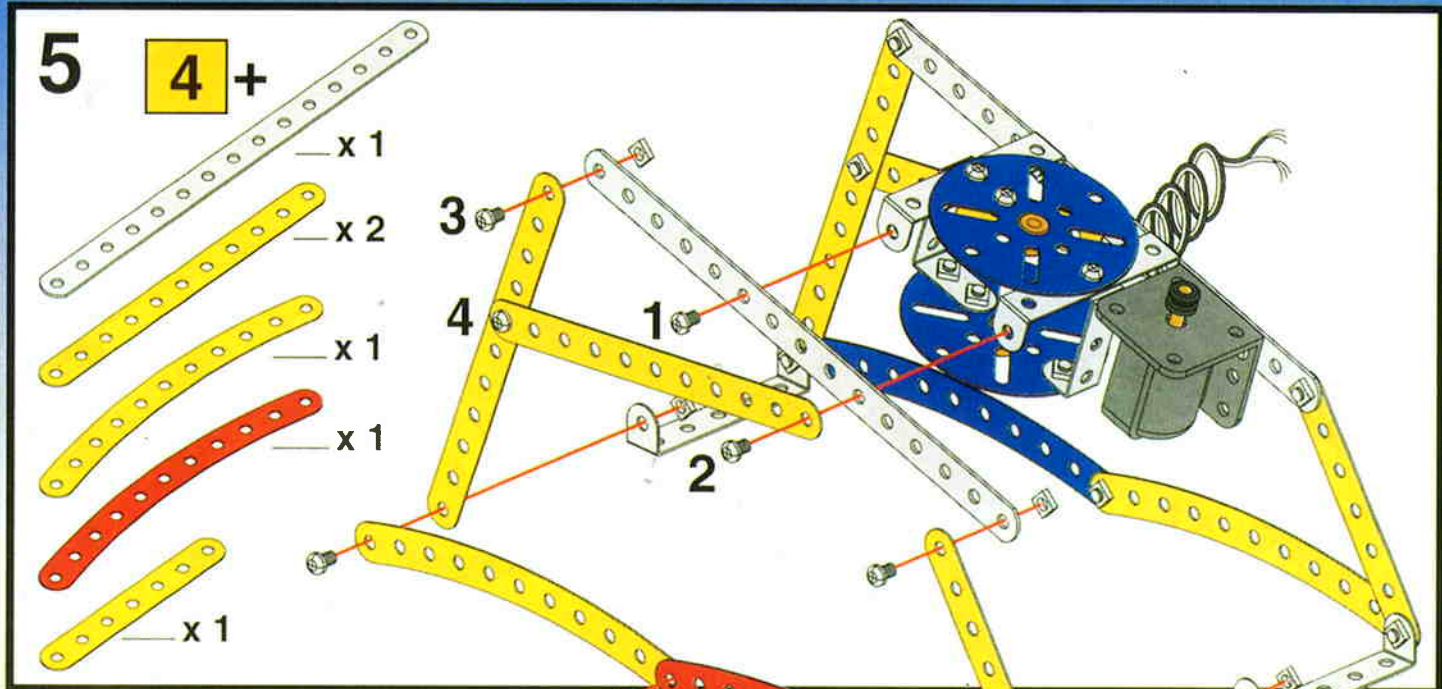
1

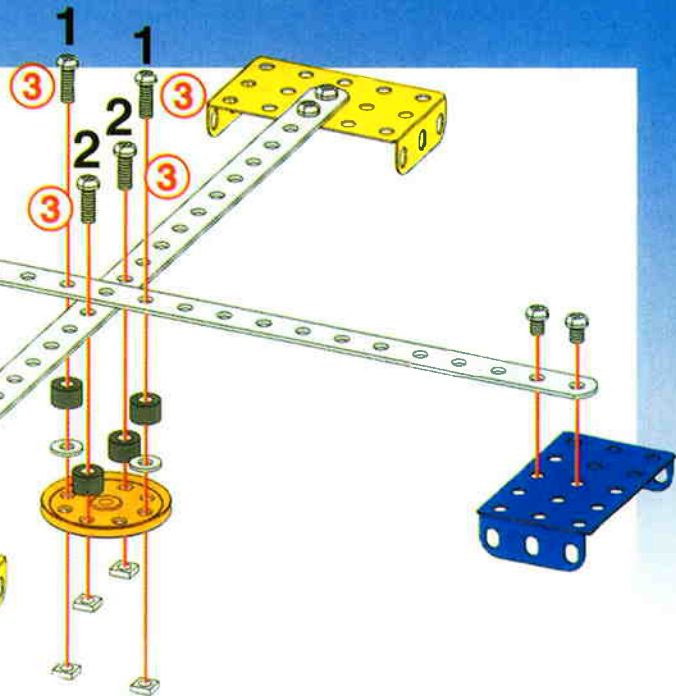
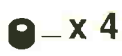
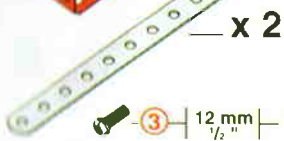
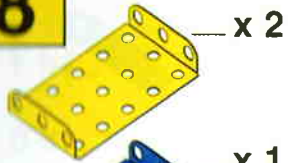
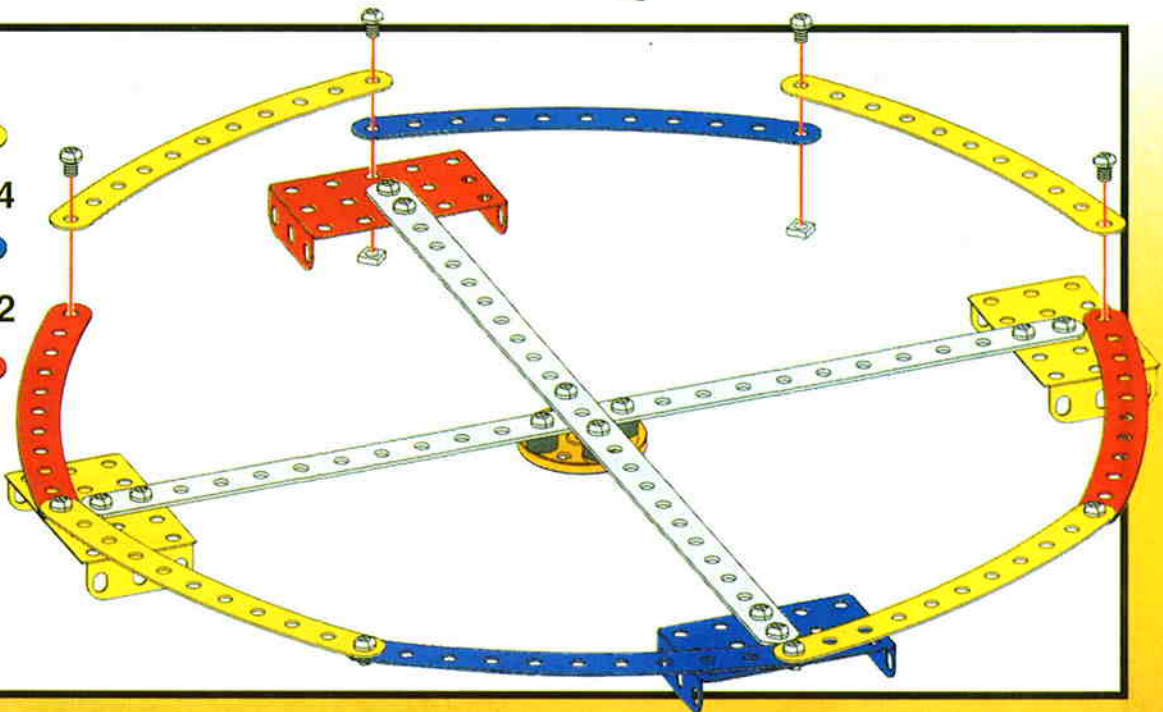
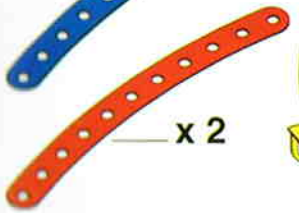
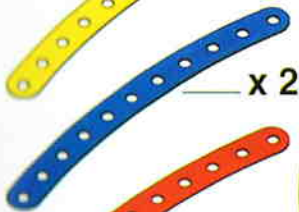
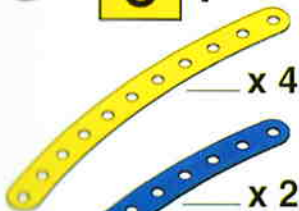
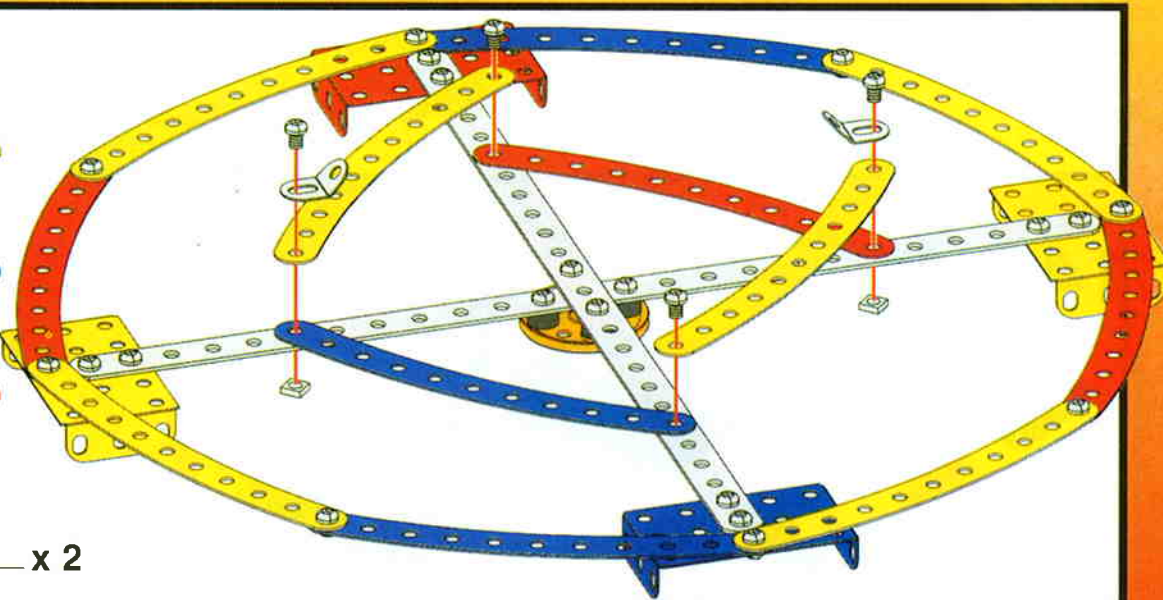
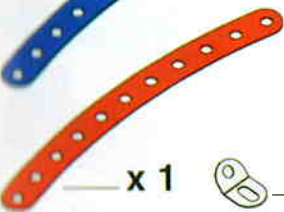
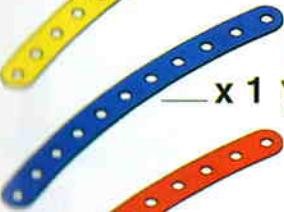
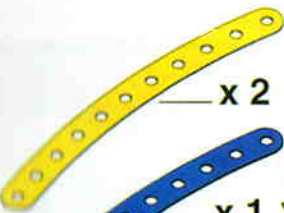



8**9****8+****10****9+**



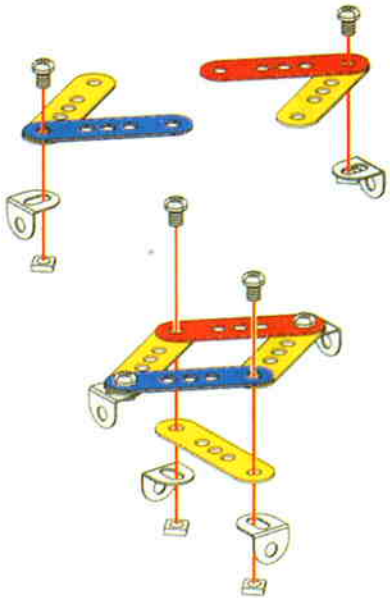

11

-  x 3
-  x 1
-  x 1
-  x 4



12

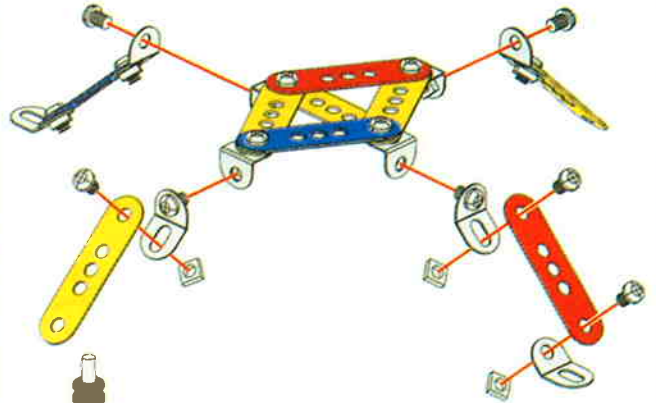

11 +

-  x 2
-  x 1
-  x 1
-  x 6

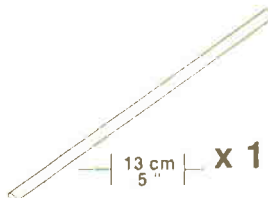

13

10 + 12 +

-  13 $\frac{5}{8}$ cm x 1
-  x 1

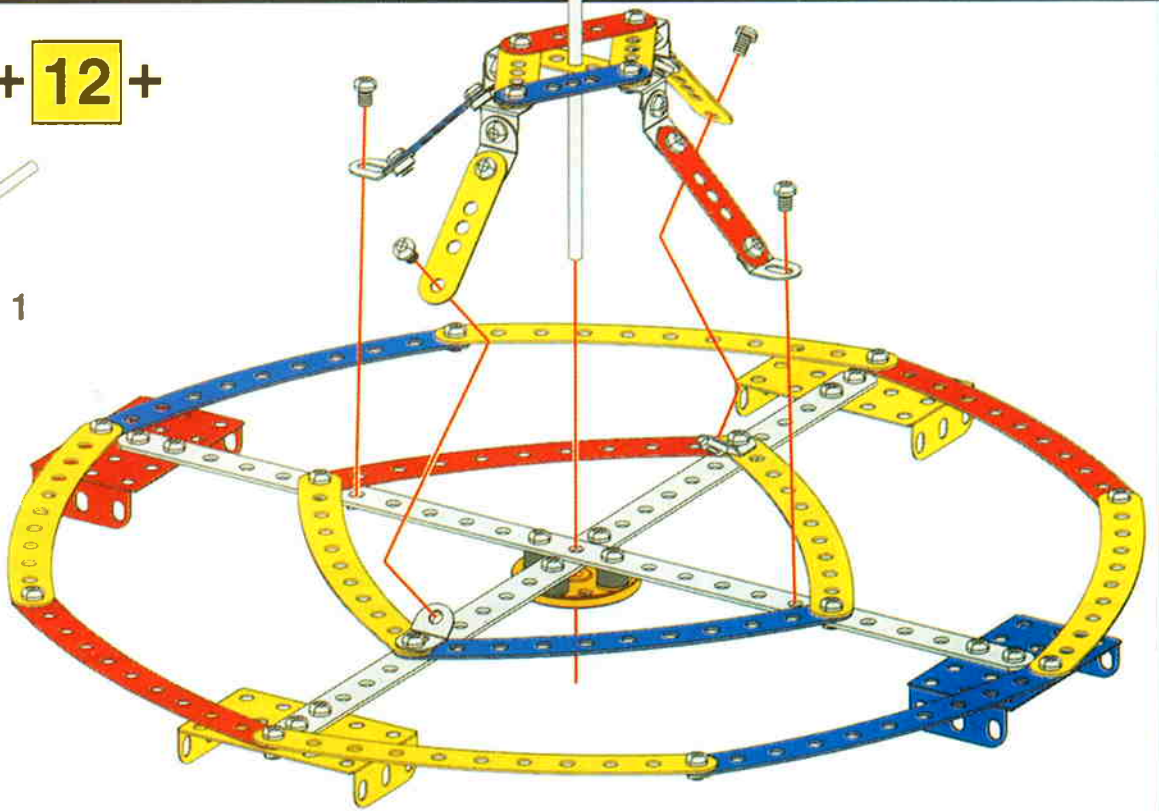

14

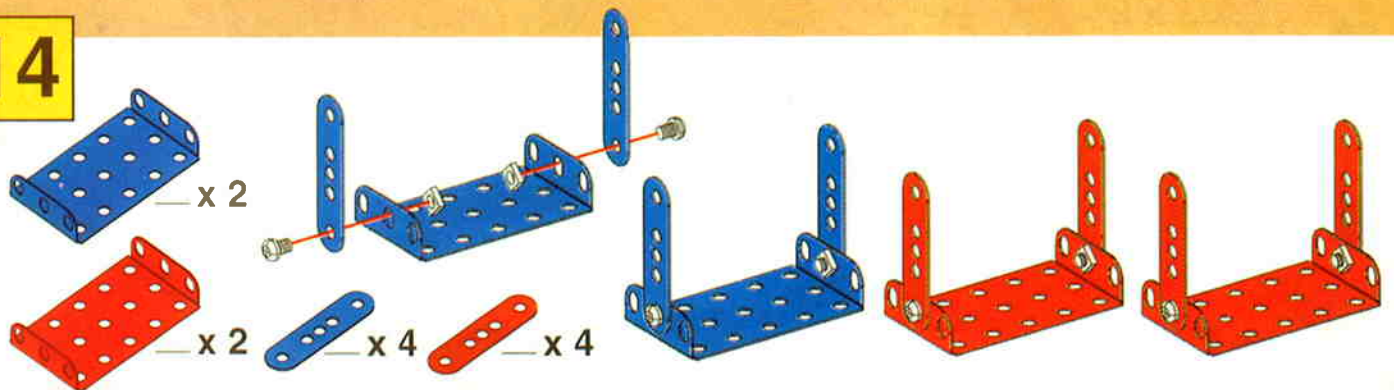



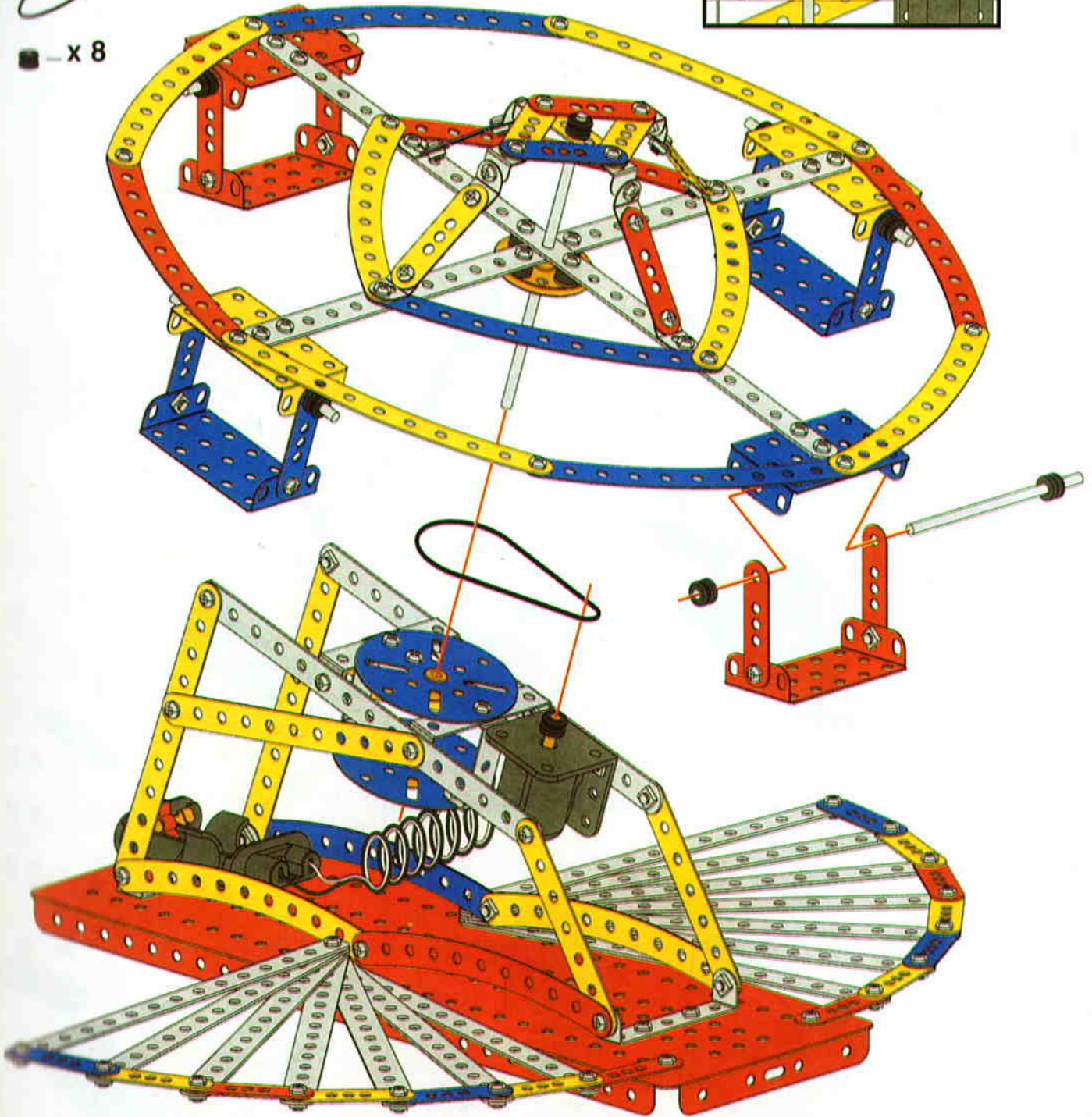
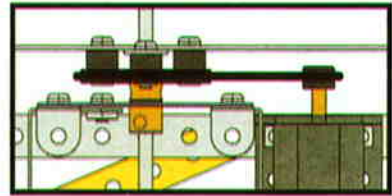

15

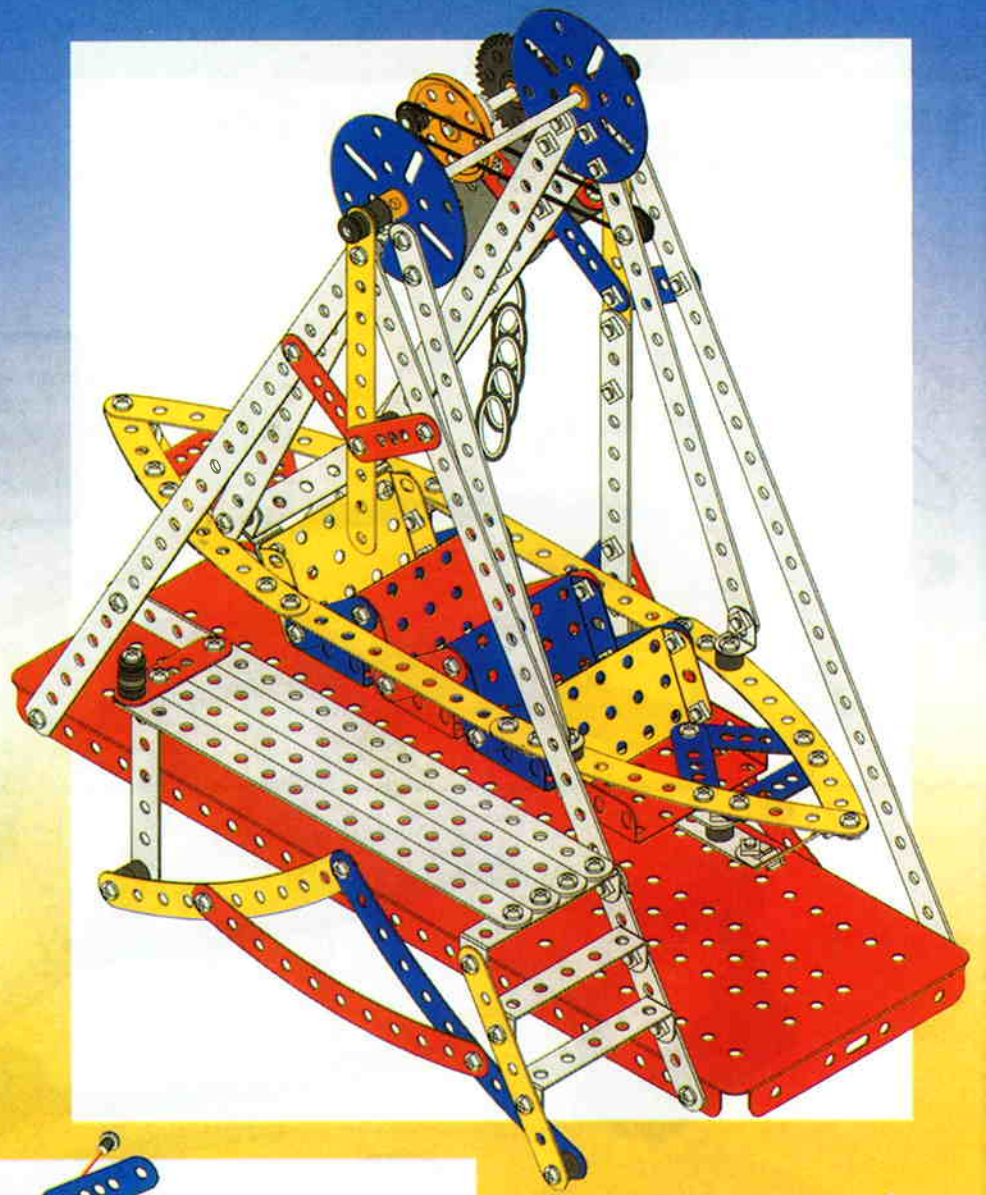
7 + 13 + 14 +



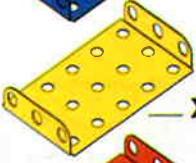



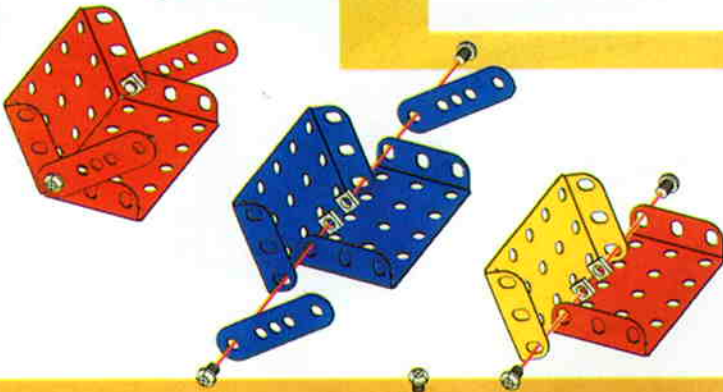

1

-  —x 2
-  —x 1
-  —x 3
-  —x 2
-  —x 2

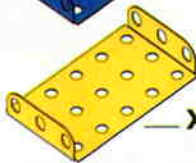

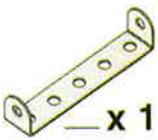
2

-  —x 1
-  —x 1
-  —x 2
-  —x 1
-  —x 2
-  —x 2

